

790	S012812/00	M5X20 - 0.3-2 - BRN KS	BLIND RIVET NUT	-	2
780	A7001302/00	ELECTRO SET	ASSY CPL S2 120V US	-	1
770	P7001241/01	COVER PLATE	HEPA FILTER WELD ASSY	-	1
760	R7500143/00	FLOOR TOOL	TO HOSE 50MM	-	1
750	R7500142/02	WAND	D50X580 - D50X498	-	1
740	A7001215/00	POWER CORD	ASSY S203 120V US	-	1
730	P7001214/00	CABLE SET MOTOR UNIT	S2 120V US	-	1
720	P7001213/00	CABLE SET COVER	S2-S3 120V US	-	1
710	S012532/00	RIVET	2.4x4 BR SDH DIN7337 A	-	4
700	P7001238/00	PRODUCT PLATE	S203 VONARX	-	1
690	S012421/00	DIN_6921, M6X20	SERRATED HEX FLANGE HEAD CAP SCREW, DIN 6921, M6X20,8.8	-	4
660	R7500121/00	NUT	PG11 - 211M	-	1
650	P7001204/01	SET	ELECTRIC MOTOR S2 120V US	-	1
640	A7001195/00	HOSE SET	VACUUM TOP S2	-	2
630	R7500013/00	QUICK LOCK	60MM	ESSENTRA NR. 135012459902	2
620	P7001097/00	STICKER	YELLOW STICKER	-	2
610	A7001064/02	HOSE	SET S2	-	1
590	P7001113/01	STICKER	VONARX FRONT	-	1
570	P7000496/01	STICKER	S2	-	2
550	P7000491/01	STICKER	PROTECTIVE EQUIPMENT	-	1
540	P7000490/00	STICKER	AIR FLOW	-	1
530	P7000485/00	STICKER	LONGOPAC	-	1
520	P7000486/01	STICKER	H-CLASSIFICATION	-	1
510	P7000489/00	STICKER	REMOVE FOR CLEANING	-	1
500	S013121/00	SCREW	M5X16 - HS BH CS FT - DIN EN ISO 7380-2	-	14
470	S106764/00	DIN EN_1661,M8x1.25,8.8	Hexagon Nut With Flange, DIN EN 1661-1998,M8x1.25,8.8	NX Standard Part	4
460	A7000255/01	COVER	ELECTRIC BOX CPL S2-S3 120V	-	1
440	P7000248/01	INLET	HEPA FILTER TOP	-	2
420	S105186/00	DIN_127_A,8,8.8	Spring Lock Washers, Form A DIN 127,8,8.8	NX Standard Part	4
410	S108640/00	DIN_4762,M8x25,8.8	Hexagon Socket Head Cap Screw, DIN EN ISO 4762 (ISO 4762-2004),M8x25,8.8	NX Standard Part	4
400	S103898/00	DIN_134,8,8.8	Plain Washer, DIN 134,8,8.8	NX Standard Part	4
390	A7001172/01	BASE FRAME	S2 CPL VONARX	-	1
330	R7500000/01	FILTER	HEPA	PULLMANN ERMATOR NR.200700070	2
150	A7001168/02	COVER	VACUUM TOP S2 VONARX	-	1
90	R7500021/00	LASH BELT	CARGO	-	1
70	P7000013/00	SEAL	TANK CYLINDRICAL	-	1
60	A7000019/00	BAG HOLDER	LONGOPAC	-	1
50	R7500016/01	FILTER	CONICAL PREFILTER	-	1
40	A7001142/02	TANK	S2 CPL VONARX	-	1
NO.	TITLE	NAME	DESCRIPTION	NOTES	QTY

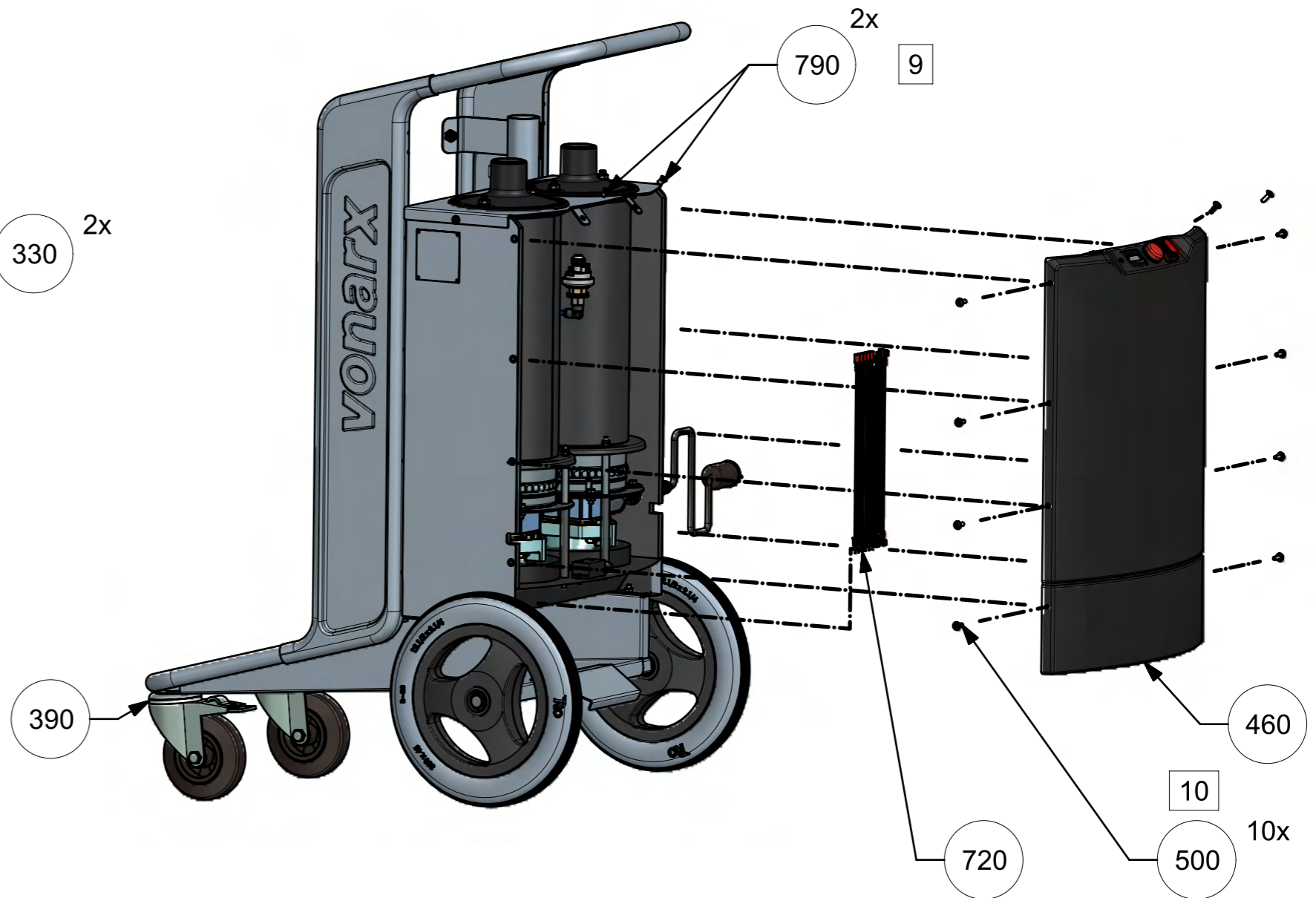

THE INFORMATION CONTAINED IN THIS DRAWING IS THE SOLE PROPERTY OF PUVAC HUNGARY KFT. REPRODUCTION IN PART OR WHOLE WITHOUT THE WRITTEN PERMISSION OF PUVAC HUNGARY KFT. PROHIBITED.

ART.NR.	P2125-18 -	REV.	01	PROJECTION	MATERIAL	
TITLE	VonArx - S203 - Vacuum Cleaner 120V US					
NOTES: -				DESIGNER	PALLAG DESIGN	PROJECT
9	Added: S012812 blind rivet nut	11.07.2023	pd2	DATE		P2125 - Puvac - Vacuum Cleaner
10	Revised: A7000255, A7001175, A7001142	21.07.2023	pd3	LAST CHANGE	PALLAG DESIGN	UNLESS OTHERWISE SPECIFIED: DIMENSIONS ARE IN MILLIMETERS. FOR UNDEFINED MACHINING TOLERANCES USE ISO 2768-MK. FOR WELDING SS-EN ISO 13920-BF, MACHINED SURFACE FINISH ACCORDING TO ISO 1302. FOR UNDEFINED GEOMETRY SEE 3D MODEL.
7	Added: A7001196, A7001197, R7500013	27.04.2023	pd3	DATE	21-Jul-2023	
8	Revised: P7001168; Added: P7001241; +2pcs S012431	06.07.2023.	pd2	STATUS		
NO.	CHANGE	DATE	DESIGNER	SHEET 1 / 8	SIZE: A3	

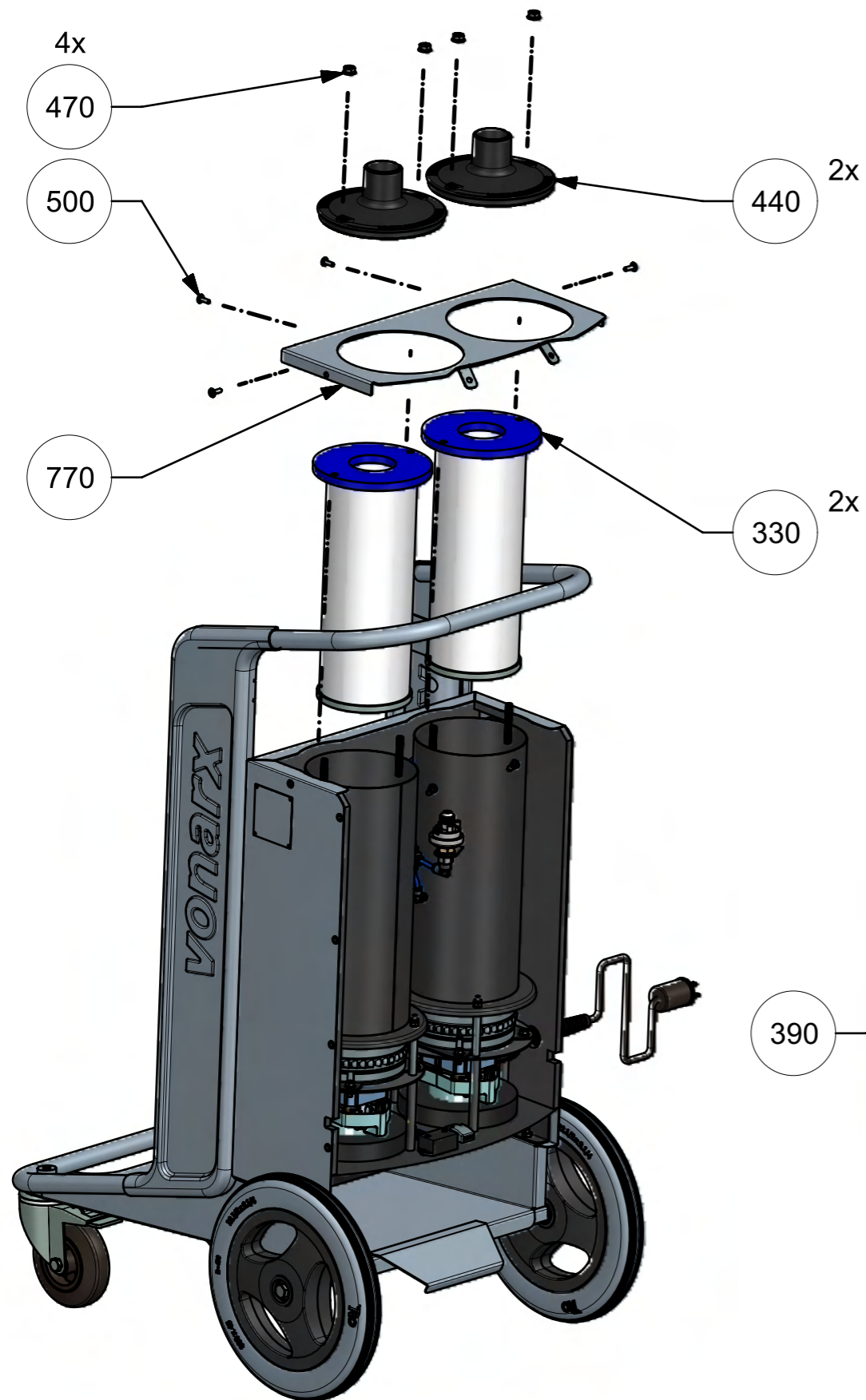

THE INFORMATION CONTAINED
IN THIS DRAWING IS THE SOLE
PROPERTY OF PUVAC HUNGARY KFT.
REPRODUCTION IN PART OR WHOLE
WITHOUT THE WRITTEN PERMISSION
OF PUVAC HUNGARY KFT. PROHIBITED.

ART.NR. P2125-18 -	REV. 01	PROJECTION 	MATERIAL	
TITLE VonArx - S203 - Vacuum Cleaner 120V US			FINISH	
NOTES: -			DESIGNER PALLAG DESIGN	PROJECT P2125 - Puvac - Vacuum Cleaner
			DATE	UNLESS OTHERWISE SPECIFIED: DIMENSIONS ARE IN MILLIMETERS. FOR UNDEFINED MACHINING TOLERANCES USE ISO 2768-MK. FOR WELDING SS-EN ISO 13920-BF, MACHINED SURFACE FINISH ACCORDING TO ISO 1302. FOR UNDEFINED GEOMETRY SEE 3D MODEL.
			LAST CHANGE 21-Jul-2023	
			STATUS	
NO.	CHANGE	DATE	DESIGNER	SIZE: A3
			SHEET 4 / 8	

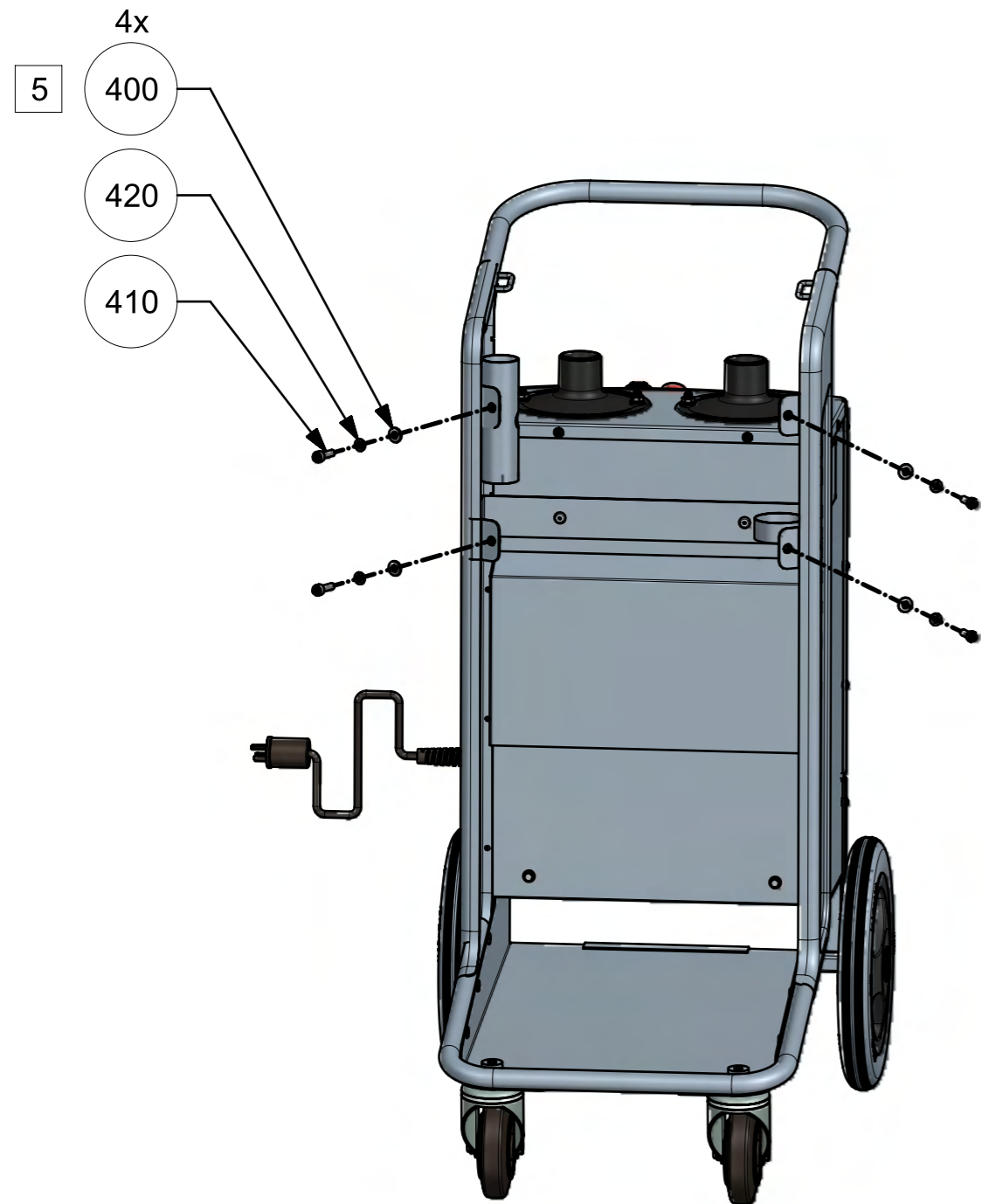

- 1
- 2
- 4
- 6

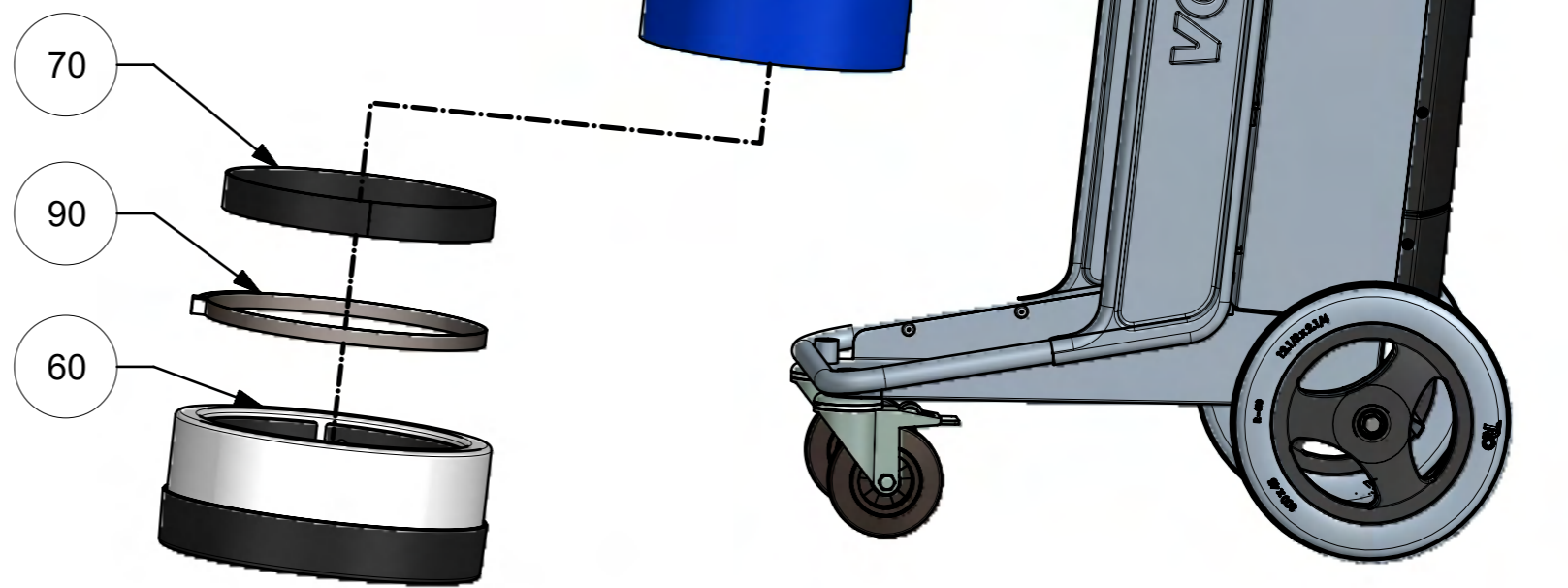

THE INFORMATION CONTAINED
IN THIS DRAWING IS THE SOLE
PROPERTY OF PUVAC HUNGARY KFT.
REPRODUCTION IN PART OR WHOLE
WITHOUT THE WRITTEN PERMISSION
OF PUVAC HUNGARY KFT. PROHIBITED.

ART.NR. P2125-18 -		REV. 01	PROJECTION 	MATERIAL	
TITLE VonArx - S203 - Vacuum Cleaner 120V US				FINISH	
NOTES: -			DESIGNER	PALLAG DESIGN	PROJECT
			DATE		P2125 - Puvac - Vacuum Cleaner
			LAST CHANGE	PALLAG DESIGN	UNLESS OTHERWISE SPECIFIED: DIMENSIONS ARE IN MILLIMETERS. FOR UNDEFINED MACHINING TOLERANCES USE ISO 2768-MK. FOR WELDING SS-EN ISO 13920-BF, MACHINED SURFACE FINISH ACCORDING TO ISO 1302. FOR UNDEFINED GEOMETRY SEE 3D MODEL.
			DATE	21-Jul-2023	
			STATUS		
NO.	CHANGE	DATE	DESIGNER	SHEET 5 / 8	SIZE: A3

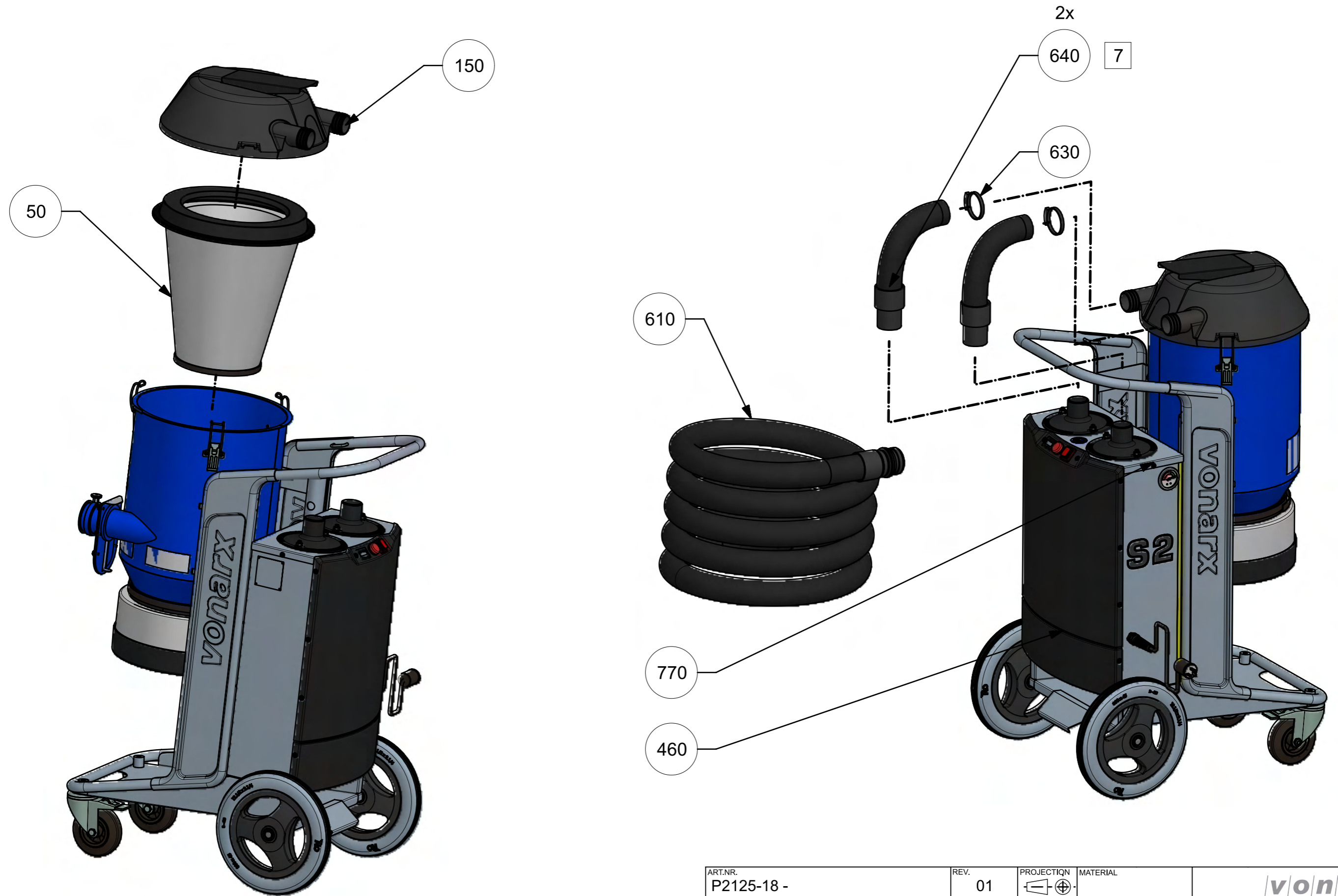

THE INFORMATION CONTAINED
 IN THIS DRAWING IS THE SOLE
 PROPERTY OF PUVAC HUNGARY KFT.
 REPRODUCTION IN PART OR WHOLE
 WITHOUT THE WRITTEN PERMISSION
 OF PUVAC HUNGARY KFT. PROHIBITED.

ART.NR. P2125-18 -	REV. 01	PROJECTION 	MATERIAL		
TITLE VonArx - S203 - Vacuum Cleaner 120V US			FINISH		
NOTES: -			DESIGNER	PALLAG DESIGN	PROJECT
			DATE		P2125 - Puvac - Vacuum Cleaner
			LAST CHANGE	PALLAG DESIGN	UNLESS OTHERWISE SPECIFIED: DIMENSIONS ARE IN MILLIMETERS. FOR UNDEFINED MACHINING TOLERANCES USE ISO 2768-MK. FOR WELDING SS-EN ISO 13920-BF, MACHINED SURFACE FINISH ACCORDING TO ISO 1302. FOR UNDEFINED GEOMETRY SEE 3D MODEL.
			DATE	21-Jul-2023	
			STATUS		
NO.	CHANGE	DATE	DESIGNER	SHEET 6 / 8	SIZE: A3

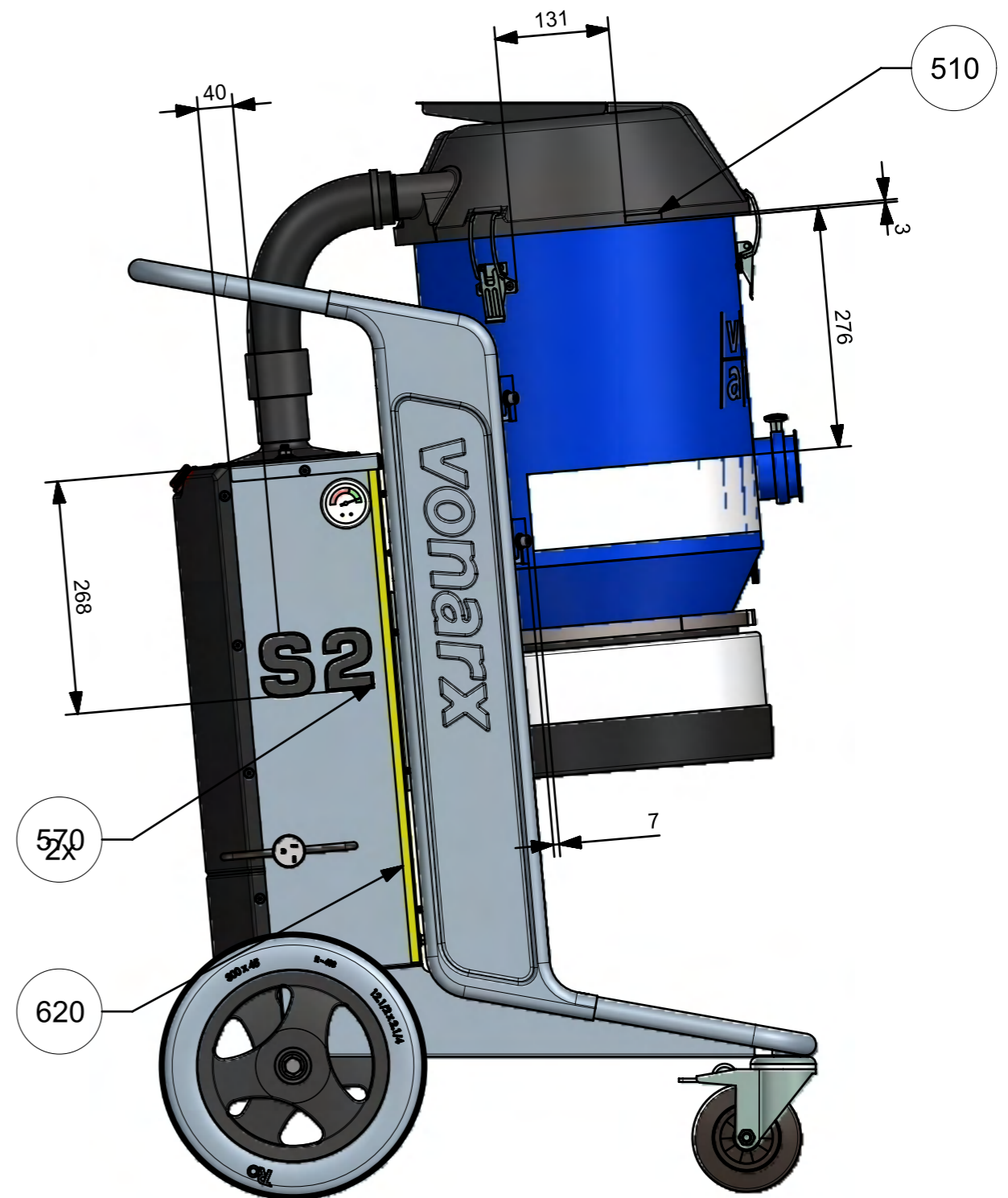
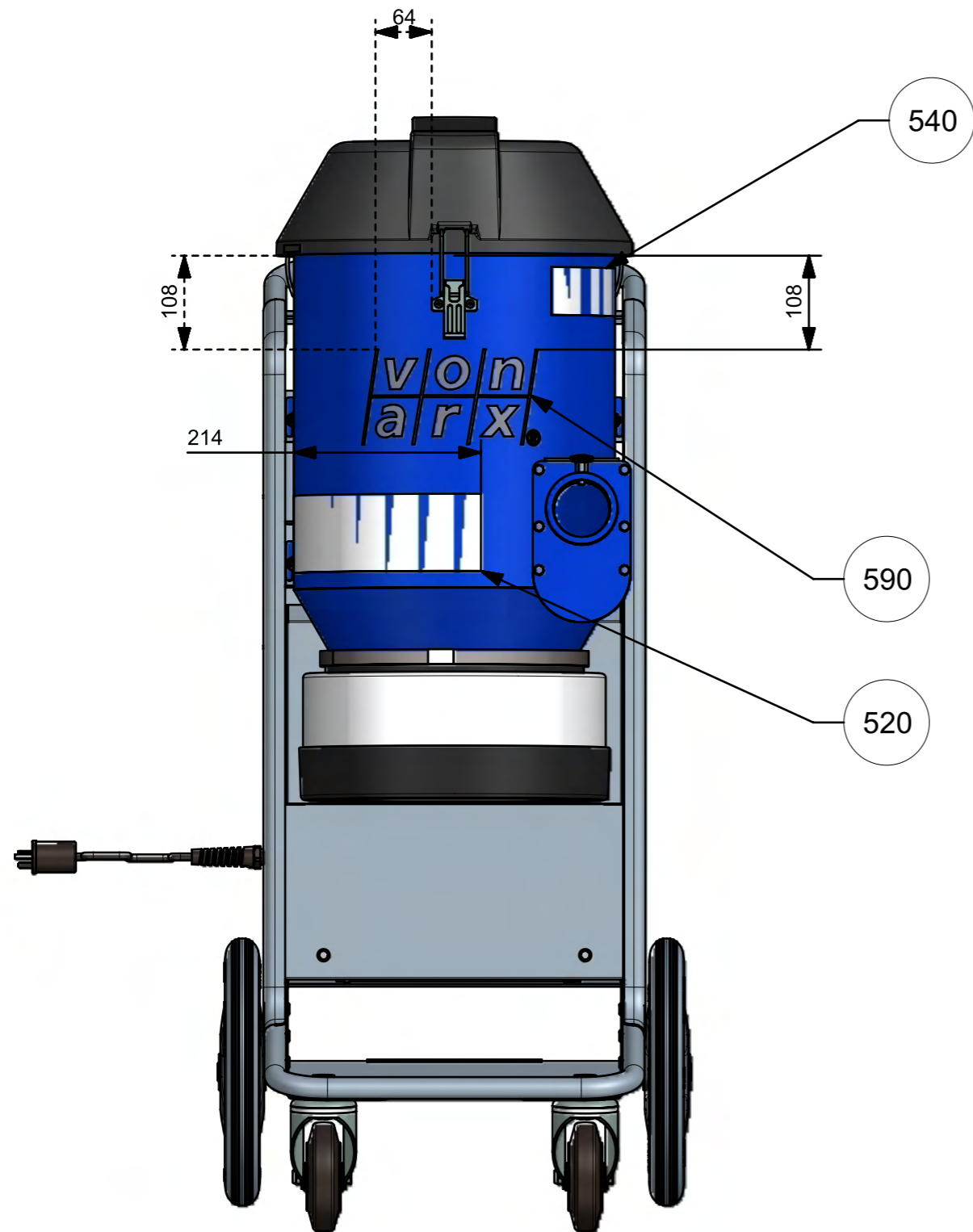

THE INFORMATION CONTAINED
IN THIS DRAWING IS THE SOLE
PROPERTY OF PUVAC HUNGARY KFT.
REPRODUCTION IN PART OR WHOLE
WITHOUT THE WRITTEN PERMISSION
OF PUVAC HUNGARY KFT. PROHIBITED.

ART.NR. P2125-18 -	REV. 01	PROJECTION 	MATERIAL		
TITLE VonArx - S203 - Vacuum Cleaner 120V US			FINISH		
NOTES: -			DESIGNER PALLAG DESIGN	PROJECT P2125 - Puvac - Vacuum Cleaner	
			DATE	UNLESS OTHERWISE SPECIFIED: DIMENSIONS ARE IN MILLIMETERS. FOR UNDEFINED MACHINING TOLERANCES USE ISO 2768-MK. FOR WELDING SS-EN ISO 13920-BF, MACHINED SURFACE FINISH ACCORDING TO ISO 1302. FOR UNDEFINED GEOMETRY SEE 3D MODEL.	
			LAST CHANGE PALLAG DESIGN		
			DATE 21-Jul-2023		
			STATUS		
NO.	CHANGE	DATE	DESIGNER	SHEET 7 / 8	SIZE: A3

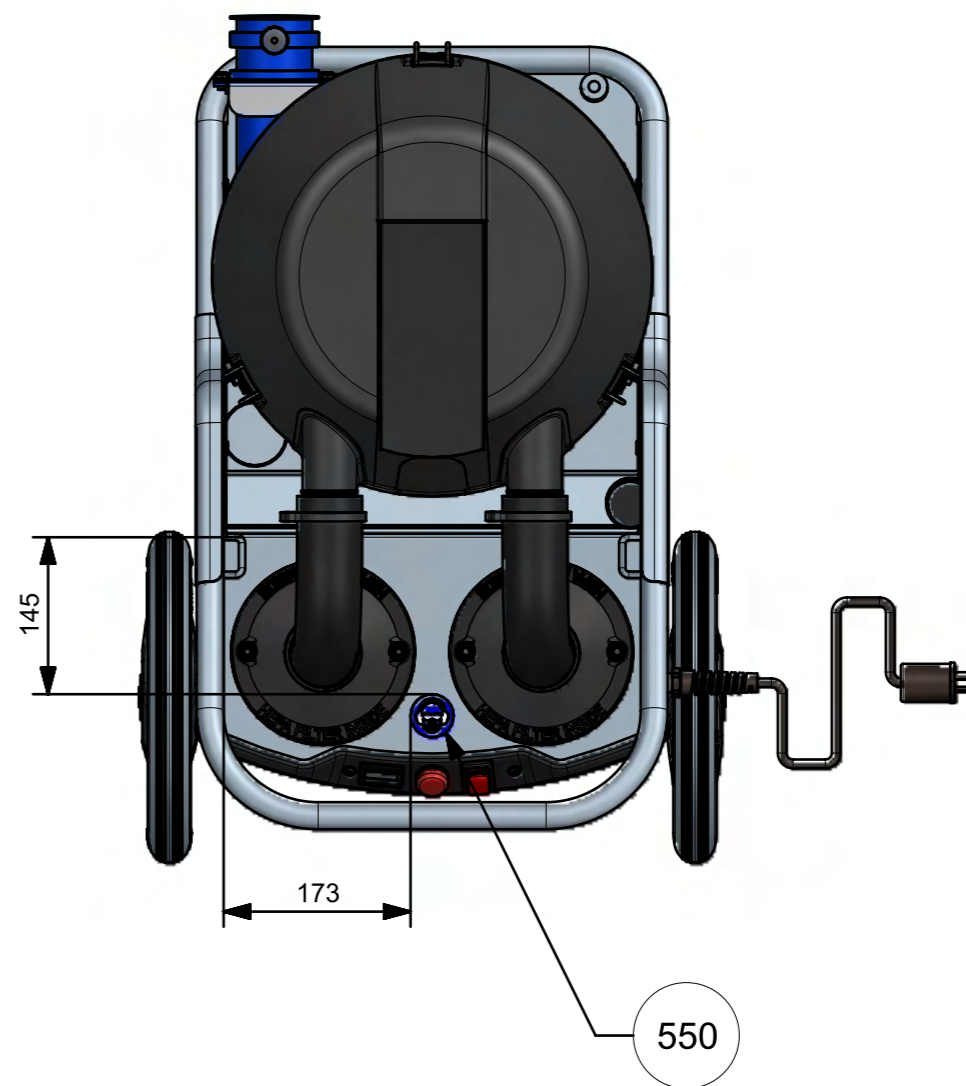
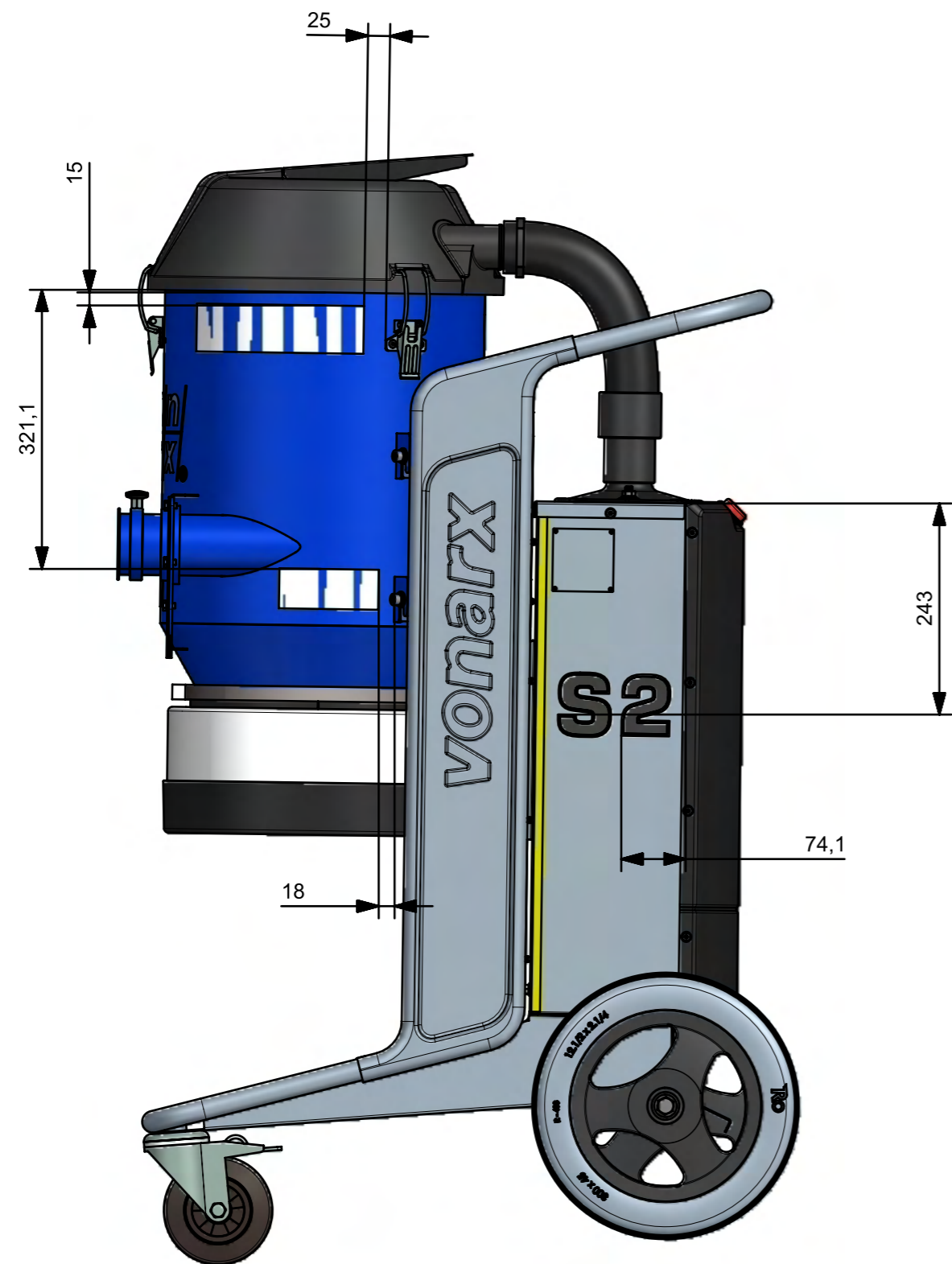

THE INFORMATION CONTAINED
IN THIS DRAWING IS THE SOLE
PROPERTY OF PUVAC HUNGARY KFT.
REPRODUCTION IN PART OR WHOLE
WITHOUT THE WRITTEN PERMISSION
OF PUVAC HUNGARY KFT. PROHIBITED.

ART.NR. P2125-18 -	REV. 01	PROJECTION 	MATERIAL		
TITLE VonArx - S203 - Vacuum Cleaner 120V US			FINISH		
NOTES: -			DESIGNER PALLAG DESIGN	PROJECT P2125 - Puvac - Vacuum Cleaner	
			DATE	UNLESS OTHERWISE SPECIFIED: DIMENSIONS ARE IN MILLIMETERS. FOR UNDEFINED MACHINING TOLERANCES USE ISO 2768-MK. FOR WELDING SS-EN ISO 13920-BF, MACHINED SURFACE FINISH ACCORDING TO ISO 1302. FOR UNDEFINED GEOMETRY SEE 3D MODEL.	
			LAST CHANGE PALLAG DESIGN		
			DATE 21-Jul-2023		
			STATUS		
NO.	CHANGE	DATE	DESIGNER	SHEET 8 / 8	SIZE: A3

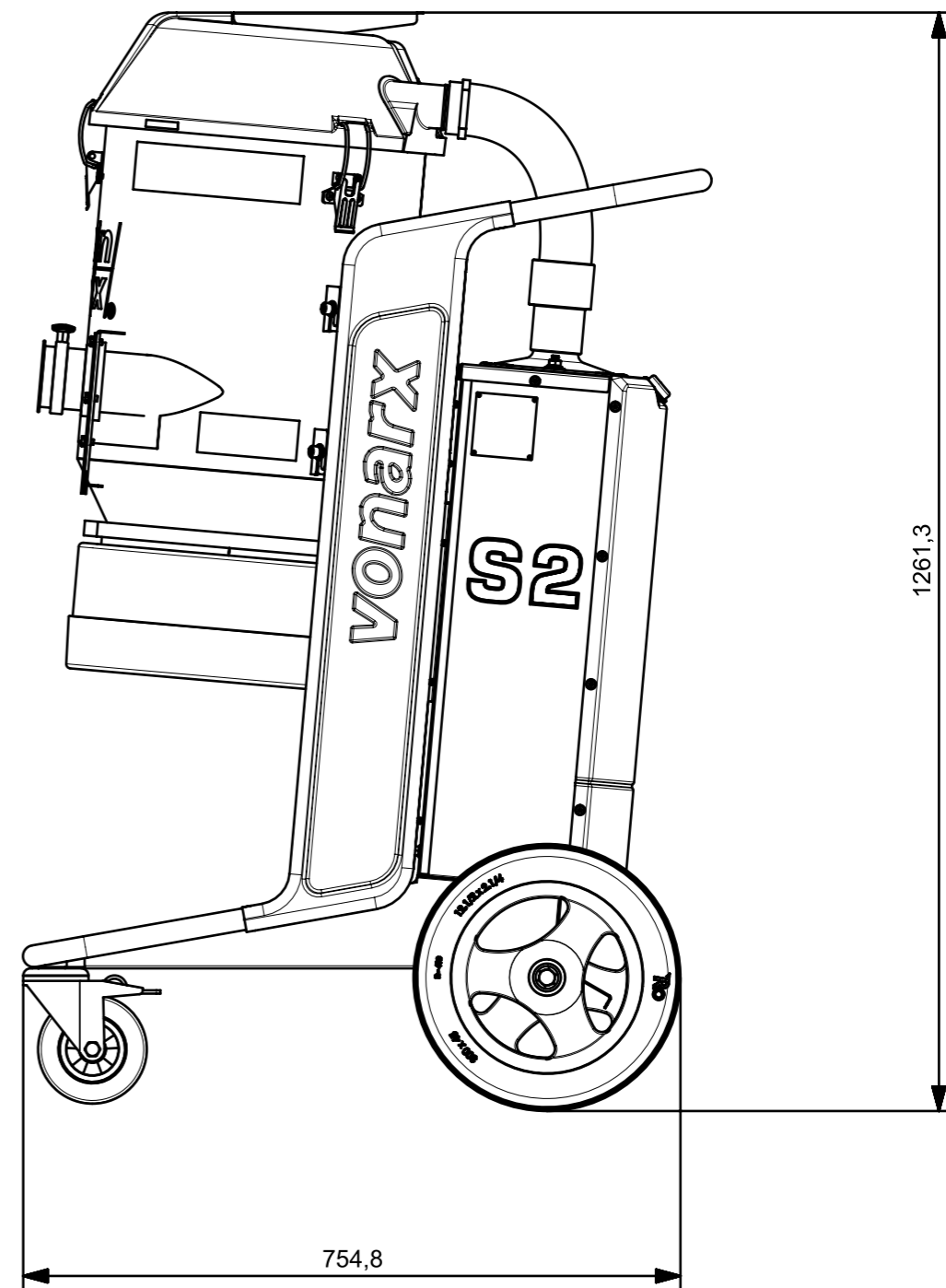
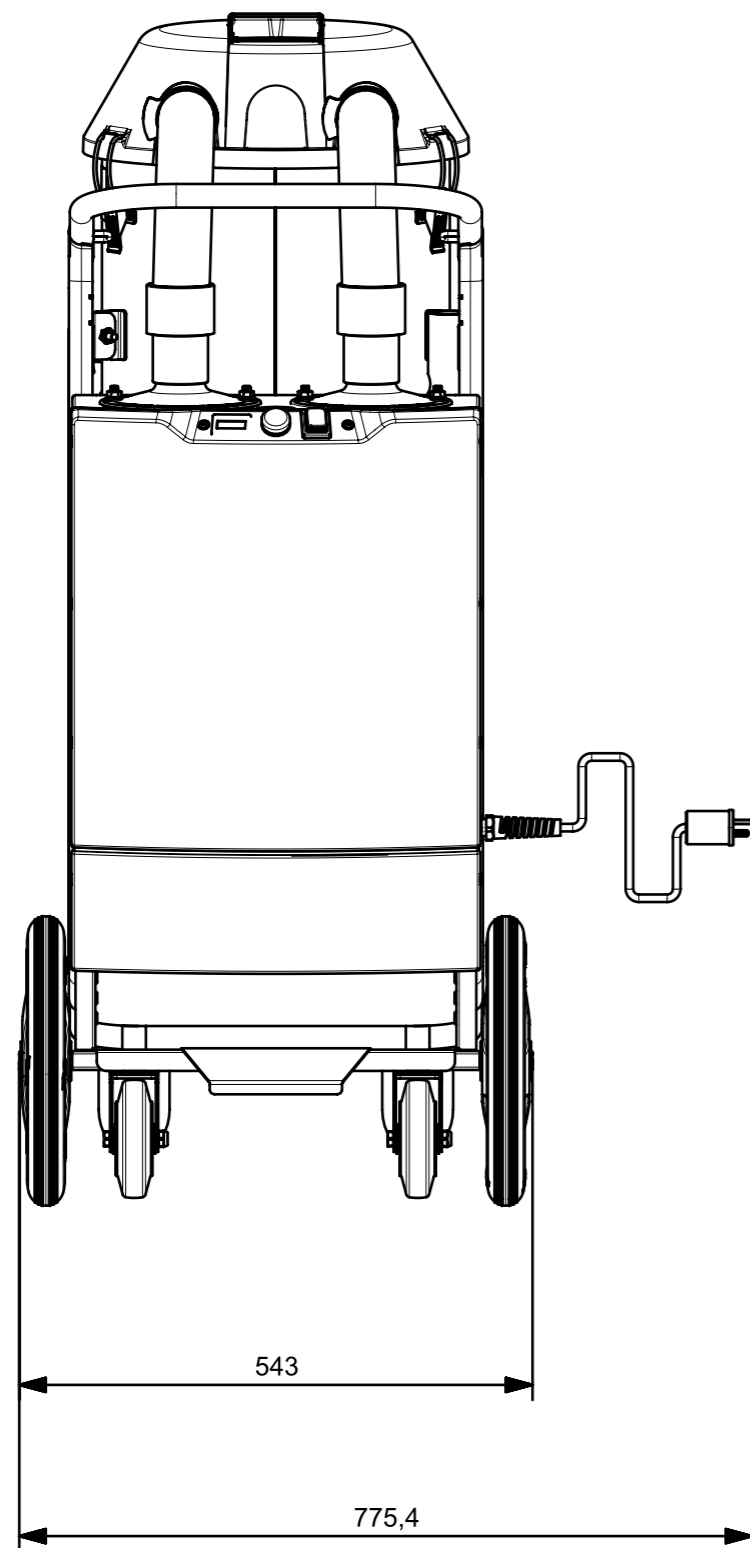

THE INFORMATION CONTAINED
IN THIS DRAWING IS THE SOLE
PROPERTY OF PUVAC HUNGARY KFT.
REPRODUCTION IN PART OR WHOLE
WITHOUT THE WRITTEN PERMISSION
OF PUVAC HUNGARY KFT. PROHIBITED.

ART.NR. P2125-18 -	REV. 01	PROJECTION 	MATERIAL		
TITLE VonArx - S203 - Vacuum Cleaner 120V US			FINISH [Finish]		
NOTES: -		DESIGNER	PALLAG DESIGN	PROJECT	
		DATE		P2125-Puvac - Vacuum Cleaner	
		LAST CHANGE	PALLAG DESIGN	UNLESS OTHERWISE SPECIFIED: DIMENSIONS ARE IN MILLIMETERS. FOR UNDEFINED MACHINING TOLERANCES USE ISO 2768-MK. FOR WELDING SS-EN ISO 13920-BF, MACHINED SURFACE FINISH ACCORDING TO ISO 1302. FOR UNDEFINED GEOMETRY SEE 3D MODEL.	
		DATE	21-Jul-2023		
		STATUS			
NO.	CHANGE	DATE	DESIGNER	SHEET 2 / 8	SIZE: A3

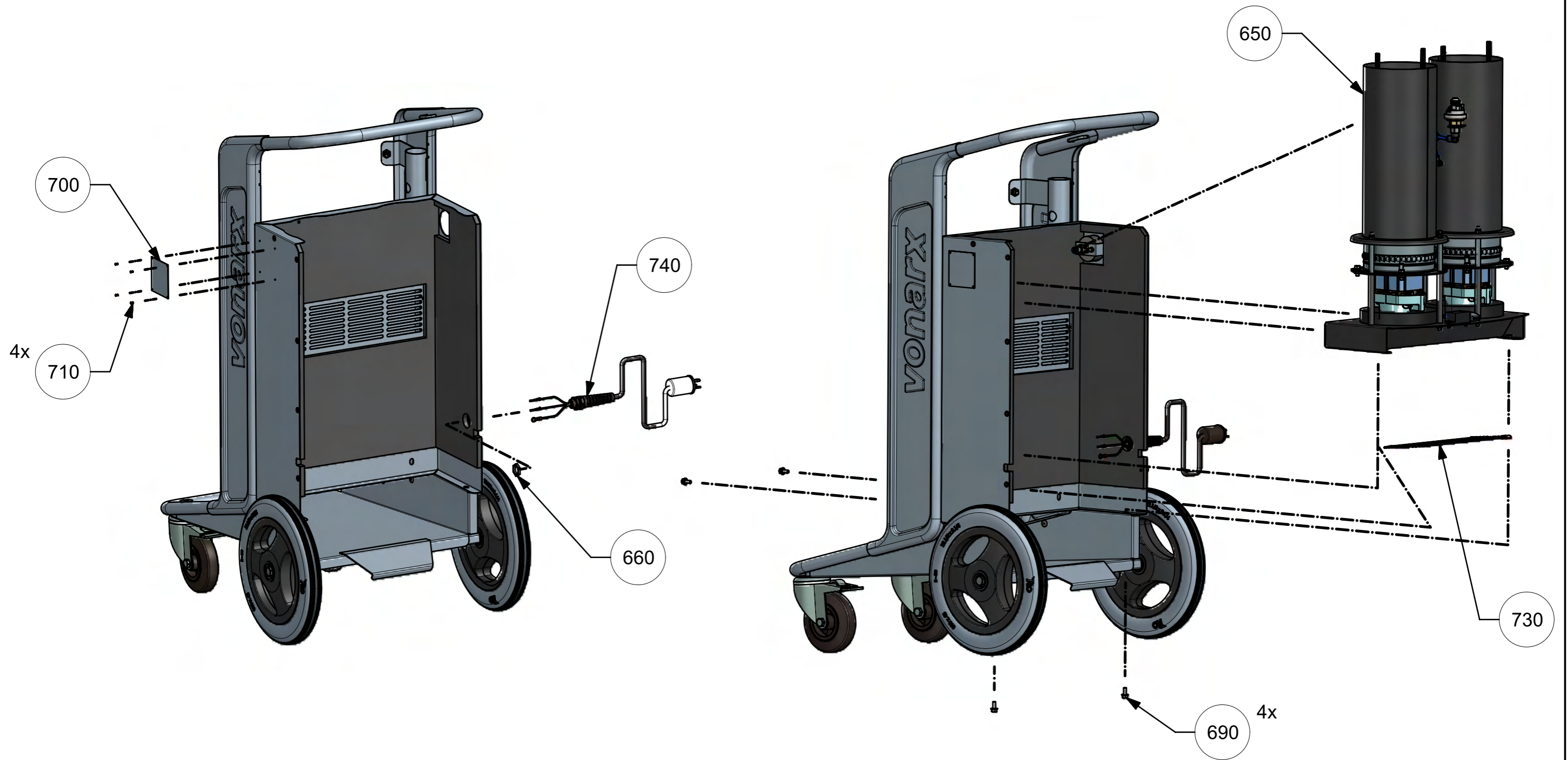

THE INFORMATION CONTAINED
 IN THIS DRAWING IS THE SOLE
 PROPERTY OF PUVAC HUNGARY KFT.
 REPRODUCTION IN PART OR WHOLE
 WITHOUT THE WRITTEN PERMISSION
 OF PUVAC HUNGARY KFT. PROHIBITED.

ART.NR. P2125-18 -	REV. 01	PROJECTION 	MATERIAL	
TITLE VonArx - S203 - Vacuum Cleaner 120V US			FINISH [Finish]	
NOTES: -			DESIGNER PALLAG DESIGN	PROJECT P2125-Puvac - Vacuum Cleaner
			DATE	UNLESS OTHERWISE SPECIFIED: DIMENSIONS ARE IN MILLIMETERS. FOR UNDEFINED MACHINING TOLERANCES USE ISO 2768-MK. FOR WELDING SS-EN ISO 13920-BF, MACHINED SURFACE FINISH ACCORDING TO ISO 1302. FOR UNDEFINED GEOMETRY SEE 3D MODEL.
			LAST CHANGE DATE 21-Jul-2023	
			STATUS	
NO.	CHANGE	DATE	DESIGNER	SIZE: A3
			SHEET 3 / 8	

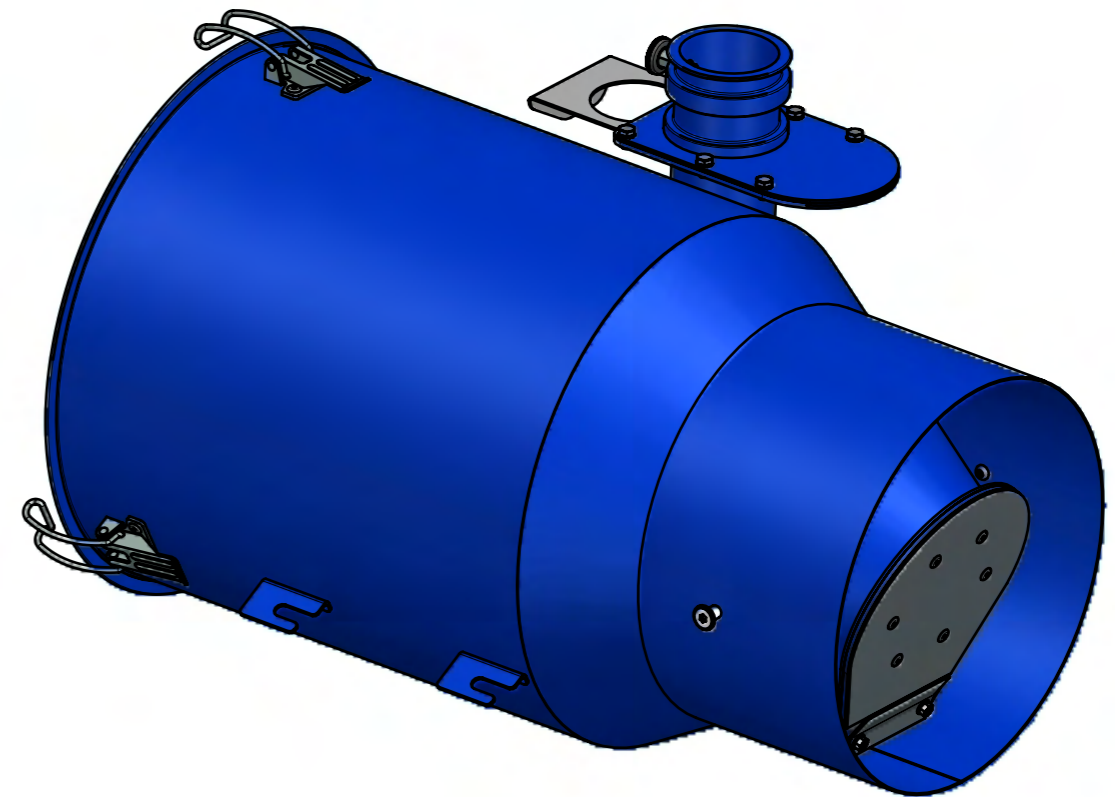
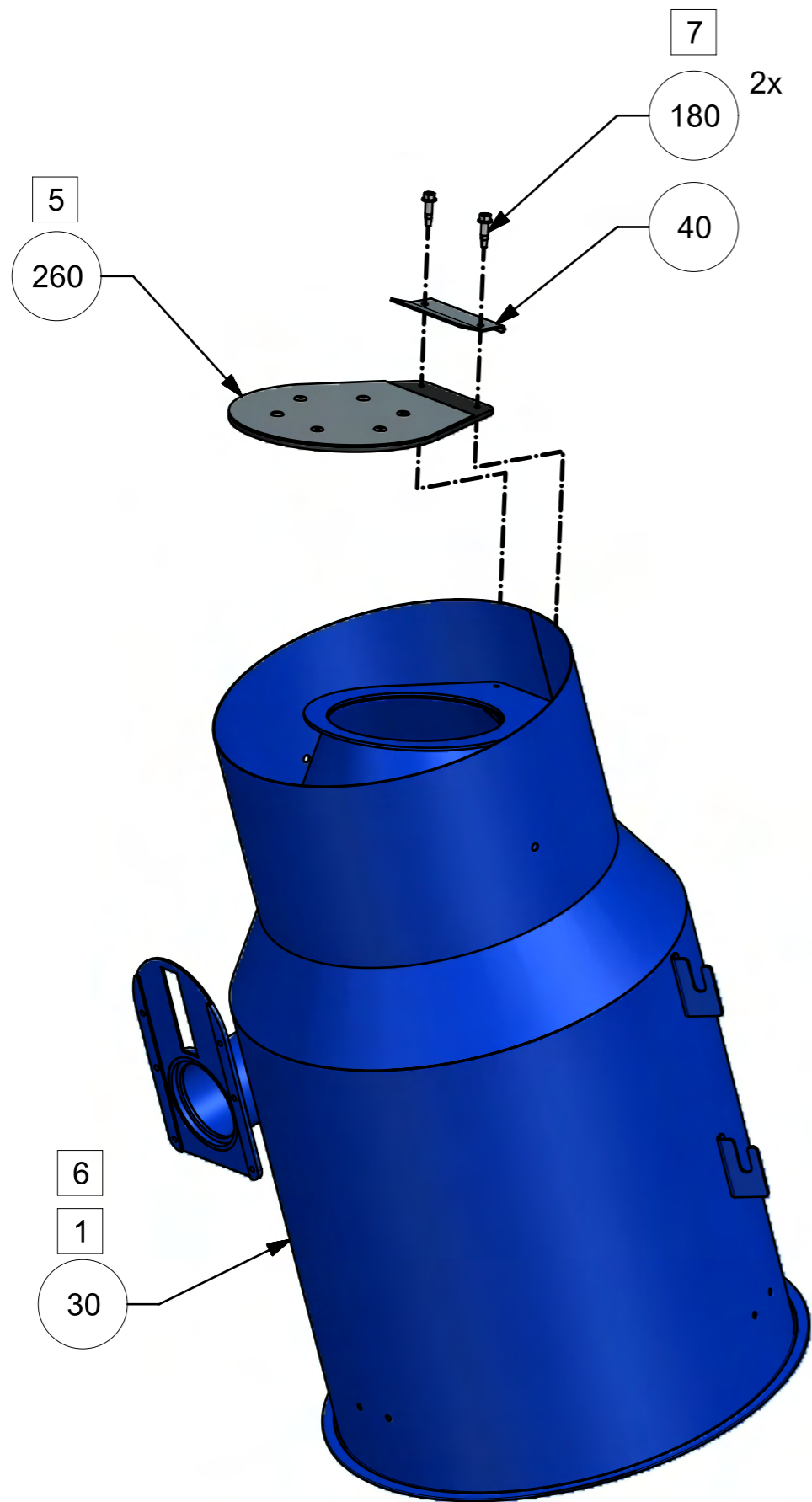

260	A7001268/00	PLATE	TANK BOT ASSY	-	1
250	S012384/00	DIN_6798_A, 6	SERRATED LOCK WASHER, DIN 6798 A, 6	-	6
240	S111544/00	DIN_4017,B,M6x10,8.8	Hexagon Head Screw, Grades A and B, DIN EN 24017 (ISO 4017-1999),M6x10,8.8	NX Standard Part	6
230	P7000405/01	SEALING	BLAST GATE	-	2
210	R7500038/00	INDEXING PLUNGER	GN.822.1-6-B-ST	ELESA NR.36425	1
200	S113667/00	DIN_7380,M6x10,10.9	Hexagon Socket Button Head Screw, DIN EN ISO 7380-2004,M6x10,10.9	NX Standard Part	2
190	S7500039/00	NUT	M6 - FLAT HEX	ESSENTRA 463194	2
180	S012422/00	DIN_7504_K, ST5.5X22	HEX HEAD SELF-DRILLING SCREW TYPE K, DIN 7504 K, ST5.5X22	-	2
160	S012416/00	ISO_15976, 4.8x12.4	SEALING BLIND RIVET, ISO 15976, 4.8X12.4	-	6
120	P7000068/03	PLATE	BLAST GATE MID	-	1
110	P7001144/02	BLAST GATE	FRONT WELD ASSY VONARX	-	1
50	R7500012/00	TOGGLE	CLAMP	TLL.Z-24/125	3
40	P7000011/01	PLATE	TANK HINGE	-	1
30	P7001143/02	TANK	S2 WELD ASSY VONARX	-	1
NO.	TITLE	NAME	DESCRIPTION	NOTES	QTY

ART.NR. 7001142 -		REV. 02	PROJECTION	MATERIAL	
TITLE TANK - S2 CPL VONARX				FINISH	
NOTES: -			DESIGNER	PALLAG DESIGN	PROJECT
5	Added: A7001268	25.05.2023	pd3	DATE	-
6	Revised: P7001143	29.06.2023	pd3	LAST CHANGE	PALLAG DESIGN
7	Revised: P7000011	30.06.2023	pd3	DATE	07-Aug-2023
4	Changed S111552	23.05.2023	pd3	STATUS	
NO.	CHANGE	DATE	DESIGNER	SHEET 1 / 3	SIZE: A3

THE INFORMATION CONTAINED IN THIS DRAWING IS THE SOLE PROPERTY OF PUVAC HUNGARY KFT. REPRODUCTION IN PART OR WHOLE WITHOUT THE WRITTEN PERMISSION OF PUVAC HUNGARY KFT. PROHIBITED.

UNLESS OTHERWISE SPECIFIED: DIMENSIONS ARE IN MILLIMETERS. FOR UNDEFINED MACHINING TOLERANCES USE ISO 2768-MK. FOR WELDING SS-EN ISO 13920-BF, MACHINED SURFACE FINISH ACCORDING TO ISO 1302. FOR UNDEFINED GEOMETRY SEE 3D MODEL.

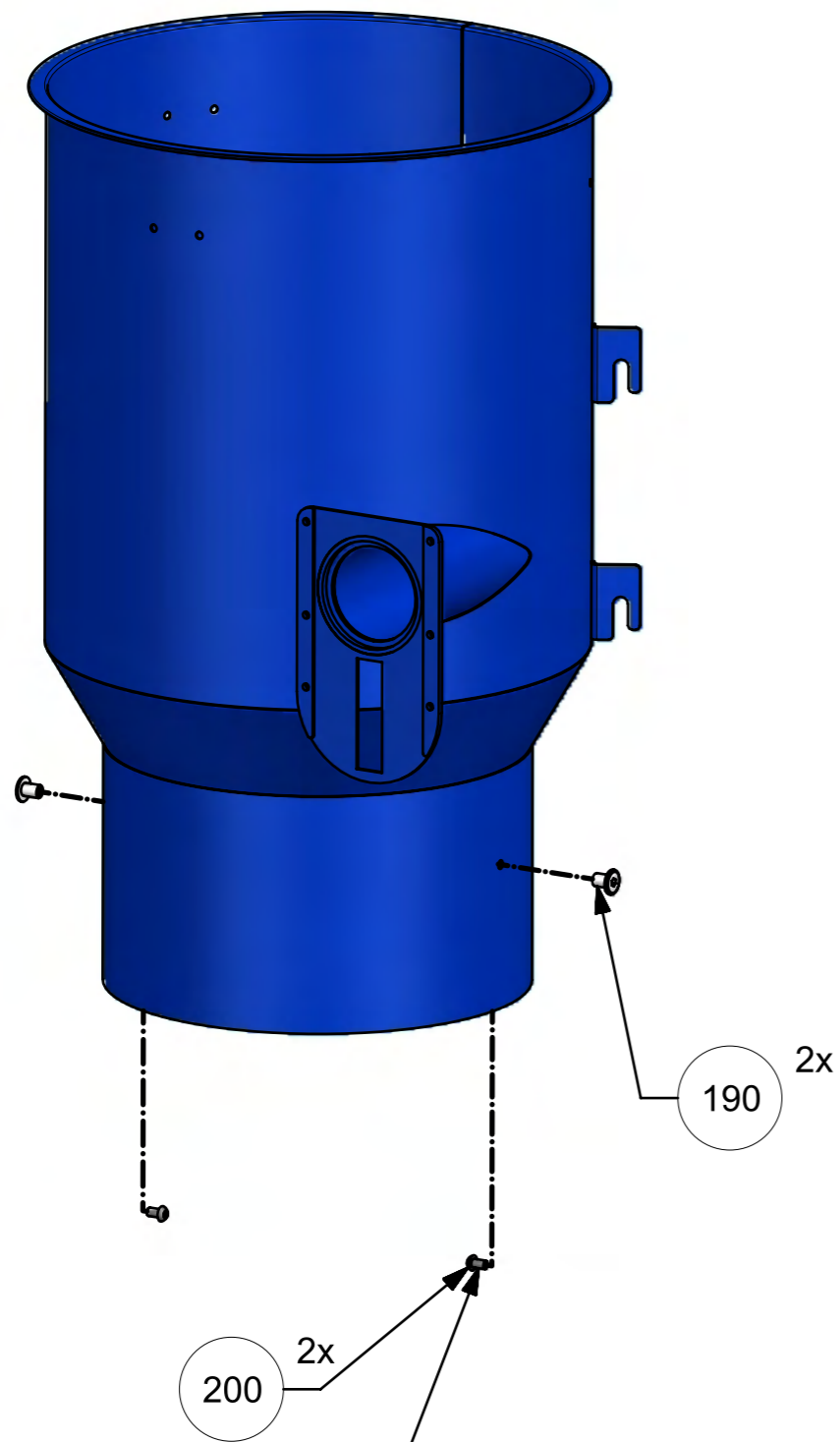

APPLY THREAD GLUE
Loctite 243

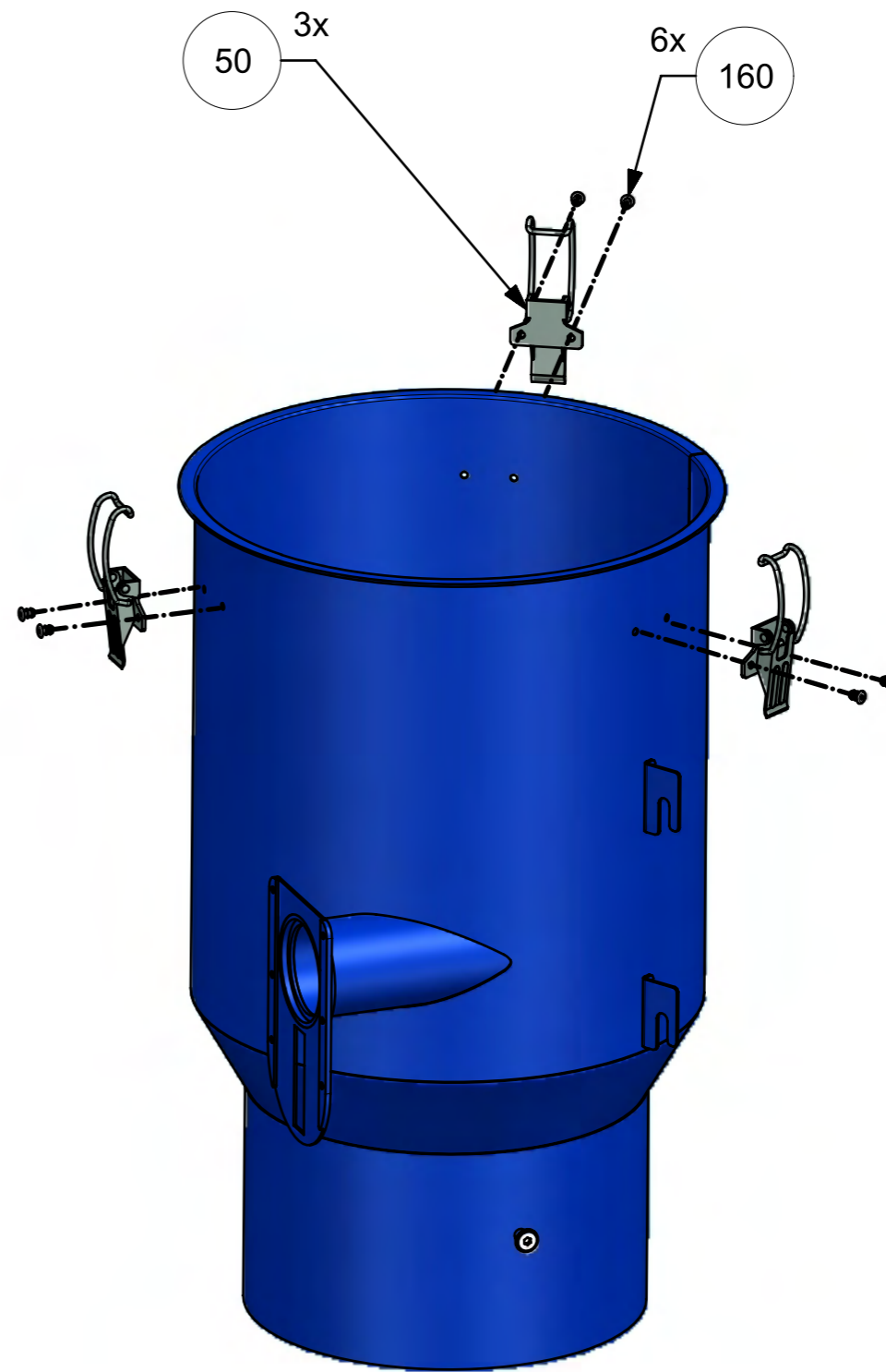

THE INFORMATION CONTAINED
IN THIS DRAWING IS THE SOLE
PROPERTY OF PUVAC HUNGARY KFT.
REPRODUCTION IN PART OR WHOLE
WITHOUT THE WRITTEN PERMISSION
OF PUVAC HUNGARY KFT. PROHIBITED.

ART.NR. 7001142 -	REV. 02	PROJECTION 	MATERIAL		
TITLE TANK - S2 CPL VONARX			FINISH		
NOTES: -			DESIGNER	PALLAG DESIGN	PROJECT
			DATE		
			LAST CHANGE	PALLAG DESIGN	UNLESS OTHERWISE SPECIFIED: DIMENSIONS ARE IN MILLIMETERS. FOR UNDEFINED MACHINING TOLERANCES USE ISO 2768-MK. FOR WELDING SS-EN ISO 13920-BF, MACHINED SURFACE FINISH ACCORDING TO ISO 1302. FOR UNDEFINED GEOMETRY SEE 3D MODEL.
			DATE	07-Aug-2023	
			STATUS		
NO.	CHANGE	DATE	DESIGNER	SHEET 2 / 3	SIZE: A3

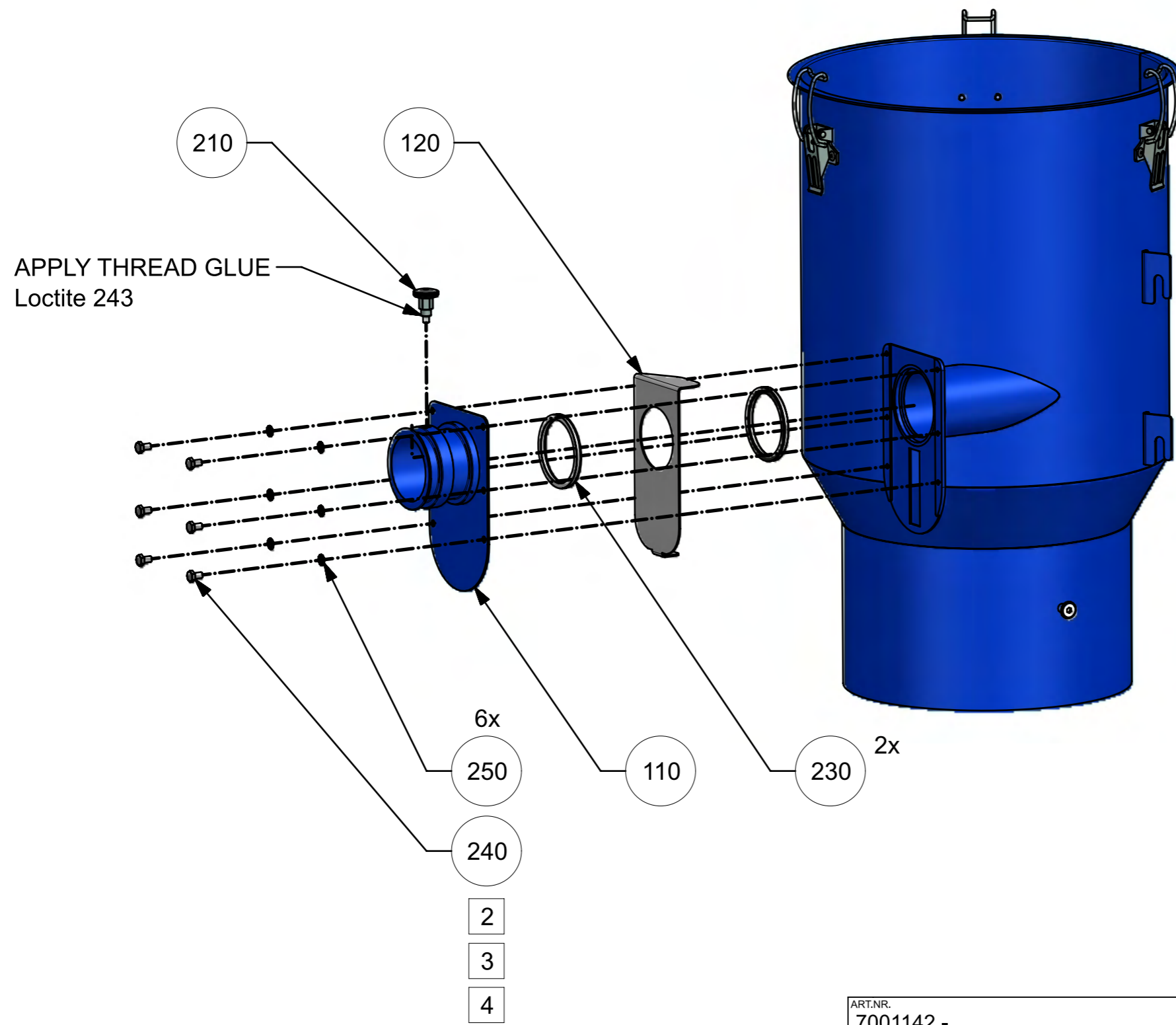

THE INFORMATION CONTAINED
IN THIS DRAWING IS THE SOLE
PROPERTY OF PUVAC HUNGARY KFT.
REPRODUCTION IN PART OR WHOLE
WITHOUT THE WRITTEN PERMISSION
OF PUVAC HUNGARY KFT. PROHIBITED.

ART.NR. 7001142 -	REV. 02	PROJECTION 	MATERIAL		
TITLE TANK - S2 CPL VONARX			FINISH		
NOTES: -			DESIGNER	PALLAG DESIGN	PROJECT
			DATE		
			LAST CHANGE	PALLAG DESIGN	UNLESS OTHERWISE SPECIFIED: DIMENSIONS ARE IN MILLIMETERS. FOR UNDEFINED MACHINING TOLERANCES USE ISO 2768-MK. FOR WELDING SS-EN ISO 13920-BF, MACHINED SURFACE FINISH ACCORDING TO ISO 1302. FOR UNDEFINED GEOMETRY SEE 3D MODEL.
			DATE	07-Aug-2023	
			STATUS		
NO.	CHANGE	DATE	DESIGNER	SHEET 3 / 3	SIZE: A3

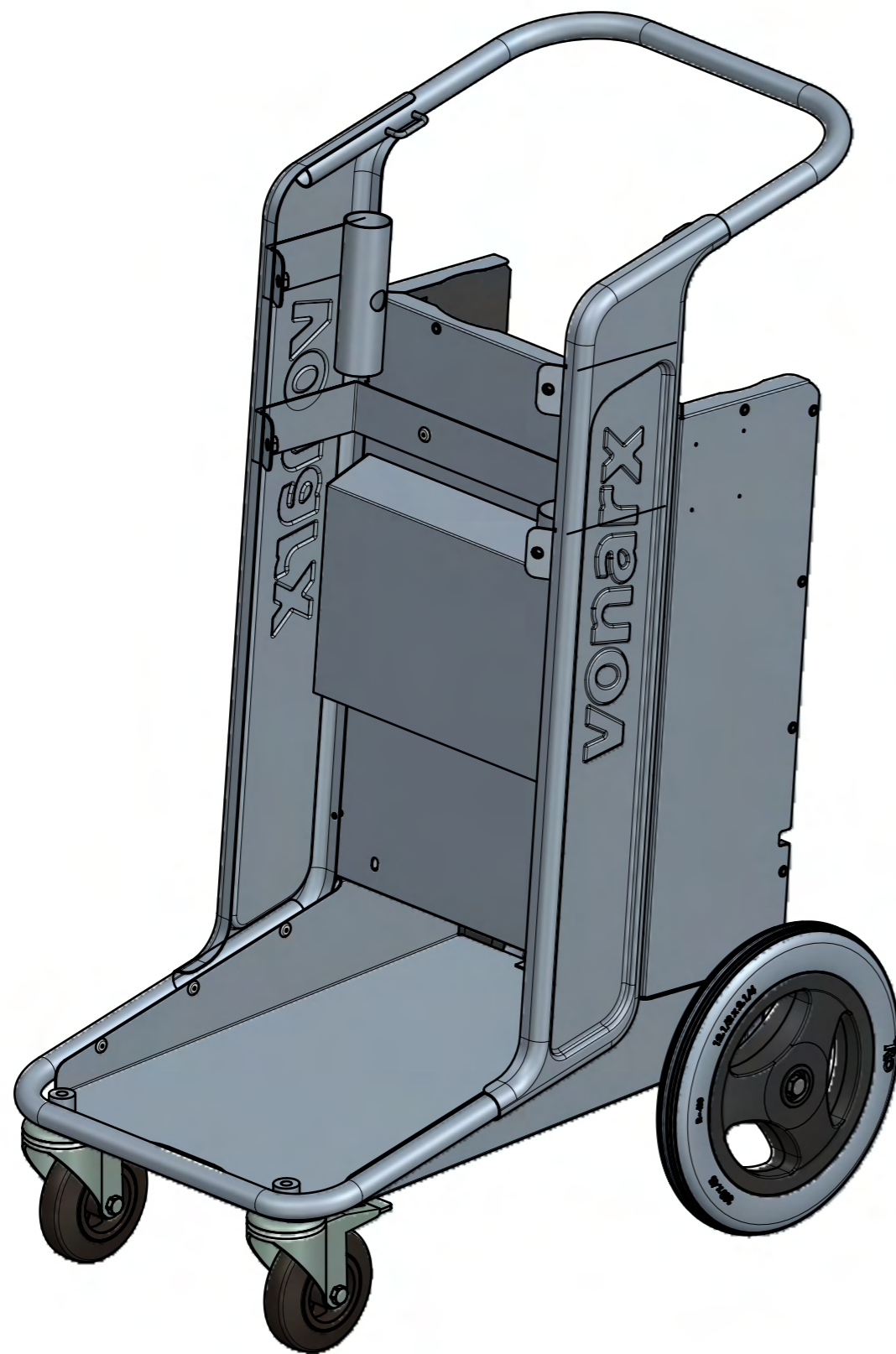

550	S106881/00	DIN_982,M5,8.8	Prevailing Torque Type Hexagon Nut, DIN 982-1987,M5,8.8	NX Standard Part	2
540	D7001263/00	PLATE	CONSOL MANOMETER	R7500002	1
530	P7001176/00	COVER	BASE FRAME VONARX	-	1
520	S114308/00	DIN_7049,B,ST4.8x9.5,8.8	Cross Recessed Pan Head Tapping Screw, Type C, Head Type Z, DIN EN ISO 7049-1983(ISO 7049-1983),ST4.8x9.5,8.8	NX Standard Part	6
510	R7500175/00	CONNECTOR	QSF-1-4 INCH - 6-B	FESTO 153024	1
440	P7001122/01	INSULATION	ELECTRIC BOX SIDE S2	-	1
430	P7001123/00	INSULATION	ELECTRIC BOX LEFT SIDE S2	-	1
300	S012812/00	M5X20 - 0.3-2 - BRN KS	BLIND RIVET NUT	-	12
260	R7500029/00	PLUG	D45 PE ROUND GLIDE	ESSENTRA NR. 1350661	1
210	R7500002/00	MANOMETER	CUSTOMIZED GAUGE DIAL	-	1
140	S111740/00	DIN_4017,B,M12x80,8.8	Hexagon Head Screw, Grades A and B, DIN EN 24017 (ISO 4017-1999),M12x80,8.8	NX Standard Part	2
130	S105194/00	DIN_127_A,12,8.8	Spring Lock Washers, Form A DIN 127,12,8.8	NX Standard Part	2
120	S104110/00	ISO_7089,12,8.8	Plain Washer, Normal Series, DIN EN ISO 7089-2000,12,8.8	NX Standard Part	2
110	S111712/00	DIN_4017,B,M12x40,8.8	Hexagon Head Screw, Grades A and B, DIN EN 24017 (ISO 4017-1999),M12x40,8.8	NX Standard Part	2
100	S012400/00	RIVET, 4.8x10	BLIND RIVET, BIG DOME HEAD, 4.8X10	-	16
70	P7000137/02	INSULATION	ELECTRIC BOX S2	-	1
60	P7001173/02	CHASSIS	S2 WELD ASSY VONARX	-	1
30	P7000945/02	MAIN FRAME	VONARX S2	-	1
20	R7500014/00	WHEEL	Ro R-403 300x45	-	2
10	R7500165/00	WHEEL	BRAKED CASTOR	5812005323SS	2
NO.	TITLE	NAME	DESCRIPTION	NOTES	QTY

ART.NR. 7001172 -		REV. 01	PROJECTION 	MATERIAL -		
TITLE BASE FRAME - S2 CPL VONARX				FINISH -		
NOTES: -				DESIGNER	PALLAG DESIGN	PROJECT
9	Removed: motor set, hepa filter covers, electronic parts	03.05.2023	pd3	DATE		P2125 - Puvac - Vacuum Cleaner
10	Added: D7001263, S106881	24.05.2023	pd3	LAST CHANGE	PALLAG DESIGN	UNLESS OTHERWISE SPECIFIED: DIMENSIONS ARE IN MILLIMETERS. FOR UNDEFINED MACHINING TOLERANCES USE ISO 2768-MK. FOR WELDING SS-EN ISO 13920-BF, MACHINED SURFACE FINISH ACCORDING TO ISO 1302. FOR UNDEFINED GEOMETRY SEE 3D MODEL.
11	Revised: P7001173, P7001114	03.07.2023	pd3	DATE	19-Jul-2023	
12	Removed: P7001114, S012400 (4 pieces); revised: P7001173	13.07.2023	pd3	STATUS		
NO.	CHANGE	DATE	DESIGNER	SHEET 1 / 5		SIZE: A3

THE INFORMATION CONTAINED IN THIS DRAWING IS THE SOLE PROPERTY OF PUVAC HUNGARY KFT. REPRODUCTION IN PART OR WHOLE WITHOUT THE WRITTEN PERMISSION OF PUVAC HUNGARY KFT. PROHIBITED.

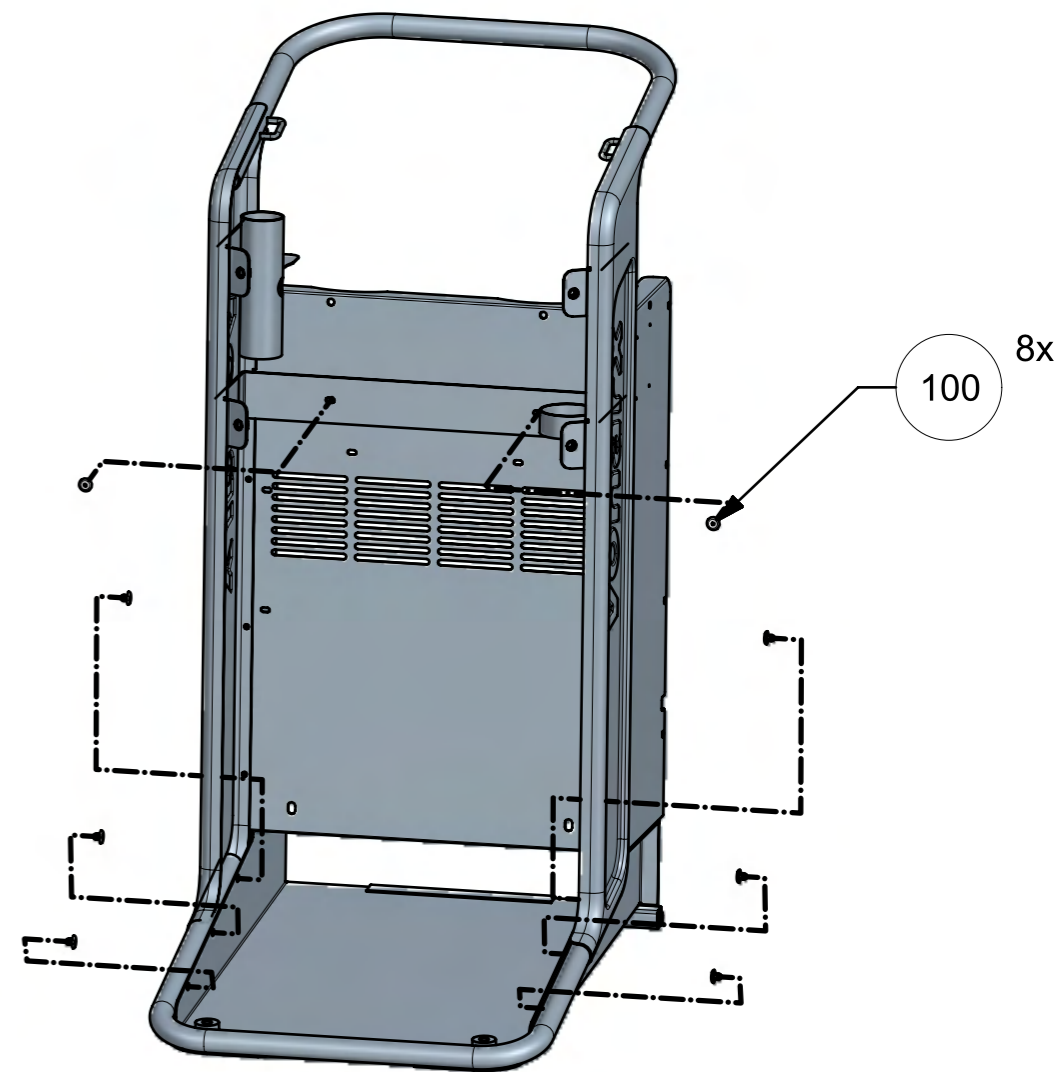
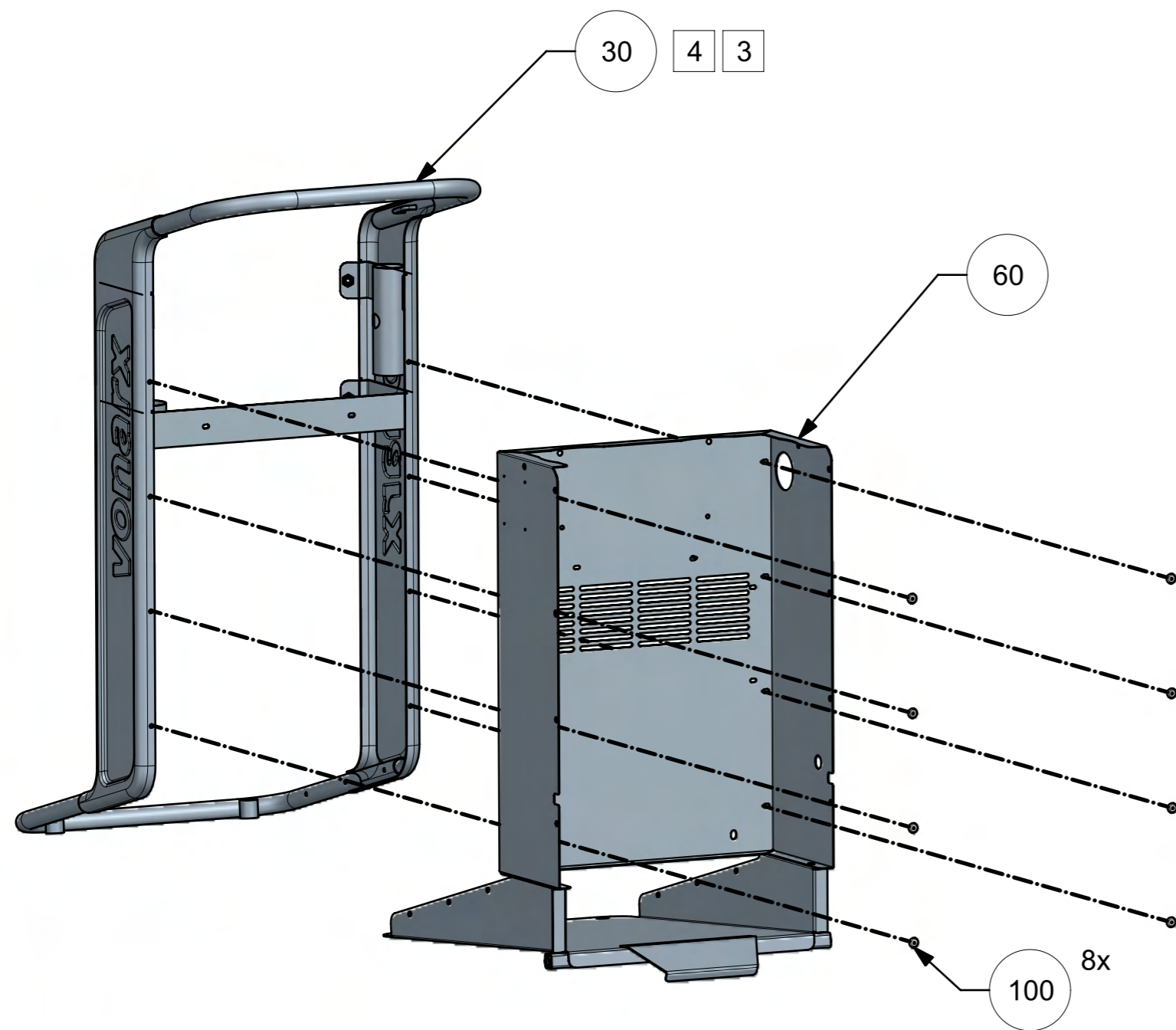

THE INFORMATION CONTAINED
IN THIS DRAWING IS THE SOLE
PROPERTY OF PUVAC HUNGARY KFT.
REPRODUCTION IN PART OR WHOLE
WITHOUT THE WRITTEN PERMISSION
OF PUVAC HUNGARY KFT. PROHIBITED.

ART.NR. 7001172 -		REV. 01	PROJECTION 	MATERIAL	
TITLE BASE FRAME - S2 CPL VONARX				FINISH -	
NOTES: -			DESIGNER	PALLAG DESIGN	PROJECT
			DATE		P2125 - Puvac - Vacuum Cleaner
			LAST CHANGE	PALLAG DESIGN	UNLESS OTHERWISE SPECIFIED: DIMENSIONS ARE IN MILLIMETERS. FOR UNDEFINED MACHINING TOLERANCES USE ISO 2768-MK, FOR WELDING SS-EN ISO 13920-BF, MACHINED SURFACE FINISH ACCORDING TO ISO 1302. FOR UNDEFINED GEOMETRY SEE 3D MODEL.
			DATE	19-Jul-2023	
			STATUS		
NO.	CHANGE	DATE	DESIGNER	SHEET 2 / 5	SIZE: A3

4 5 6 8 9 11 12

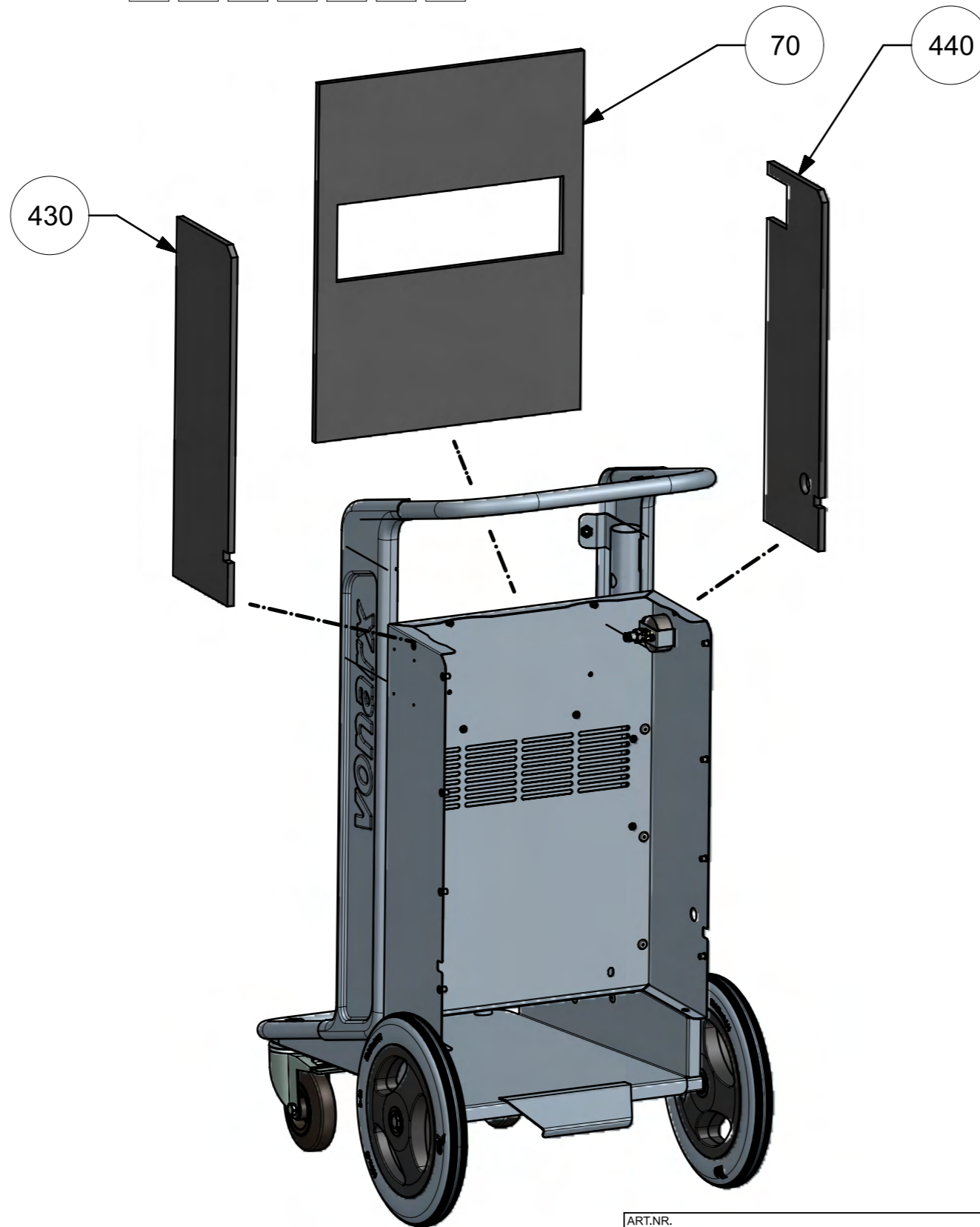

THE INFORMATION CONTAINED
IN THIS DRAWING IS THE SOLE
PROPERTY OF PUVAC HUNGARY KFT.
REPRODUCTION IN PART OR WHOLE
WITHOUT THE WRITTEN PERMISSION
OF PUVAC HUNGARY KFT. PROHIBITED.

ART.NR. 7001172 -		REV. 01	PROJECTION 	MATERIAL	
TITLE BASE FRAME - S2 CPL VONARX				FINISH -	
NOTES: -			DESIGNER	PALLAG DESIGN	PROJECT
			DATE		P2125 - Puvac - Vacuum Cleaner
			LAST CHANGE	PALLAG DESIGN	UNLESS OTHERWISE SPECIFIED: DIMENSIONS ARE IN MILLIMETERS. FOR UNDEFINED MACHINING TOLERANCES USE ISO 2768-MK. FOR WELDING SS-EN ISO 13920-BF, MACHINED SURFACE FINISH ACCORDING TO ISO 1302. FOR UNDEFINED GEOMETRY SEE 3D MODEL.
			DATE	19-Jul-2023	
			STATUS		
NO.	CHANGE	DATE	DESIGNER	SHEET 5 / 5	SIZE: A3

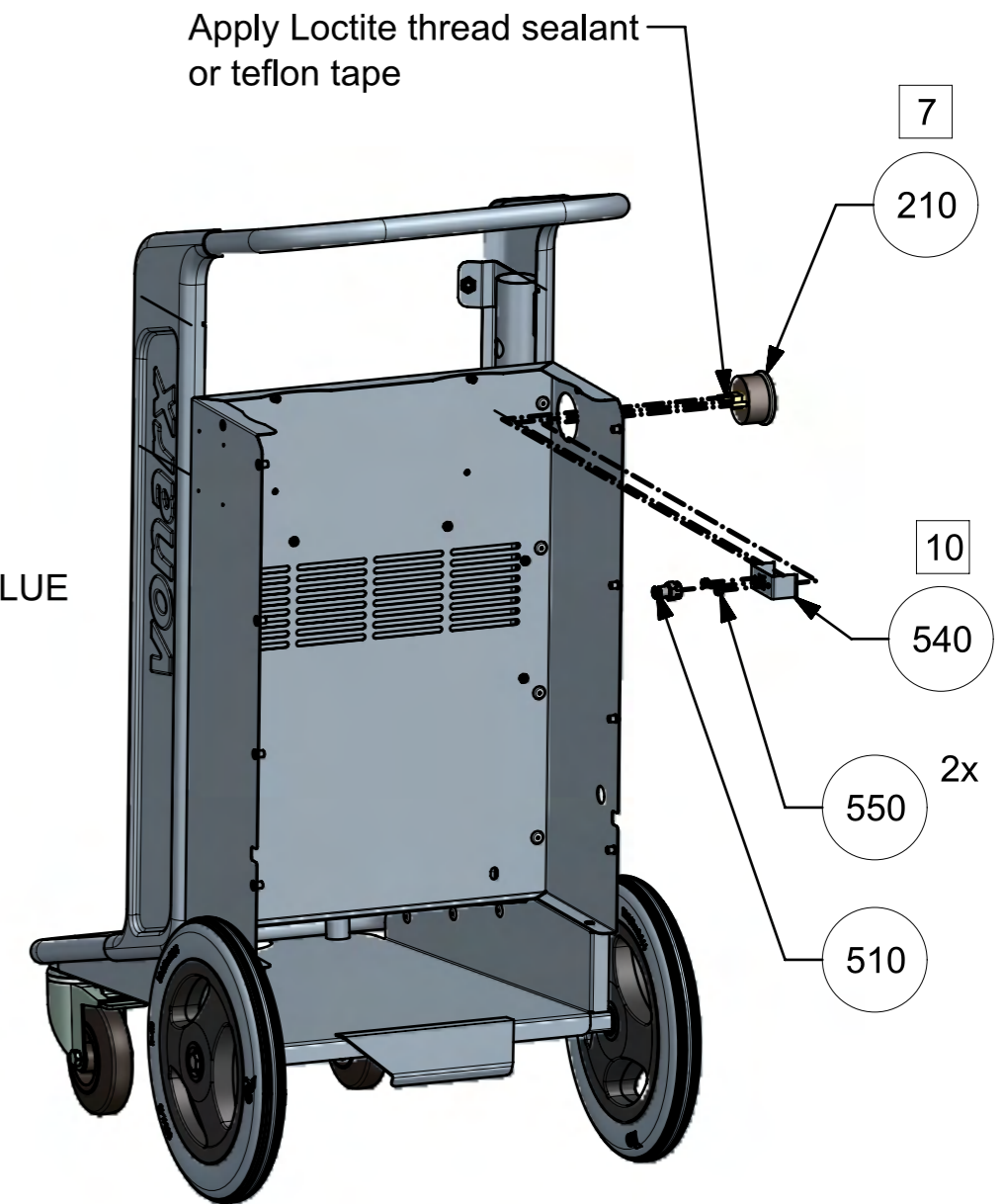
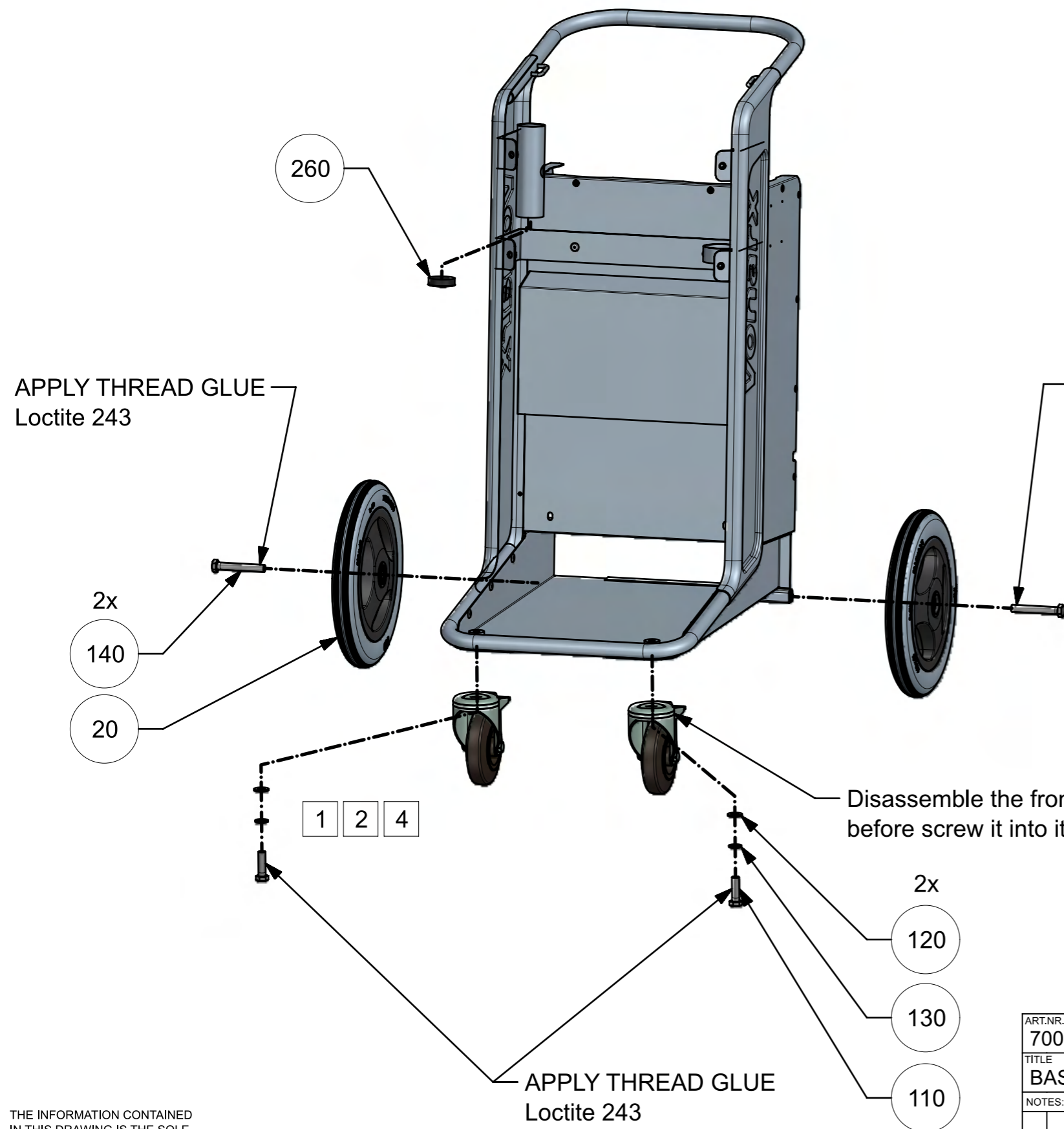

THE INFORMATION CONTAINED
IN THIS DRAWING IS THE SOLE
PROPERTY OF PUVAC HUNGARY KFT.
REPRODUCTION IN PART OR WHOLE
WITHOUT THE WRITTEN PERMISSION
OF PUVAC HUNGARY KFT. PROHIBITED.

ART.NR. 7001172 -	REV. 01	PROJECTION 	MATERIAL	
TITLE BASE FRAME - S2 CPL VONARX			FINISH -	
NOTES: -		DESIGNER PALLAG DESIGN	PROJECT P2125 - Puvac - Vacuum Cleaner	UNLESS OTHERWISE SPECIFIED: DIMENSIONS ARE IN MILLIMETERS. FOR UNDEFINED MACHINING TOLERANCES USE ISO 2768-MK. FOR WELDING SS-EN ISO 13920-BF, MACHINED SURFACE FINISH ACCORDING TO ISO 1302. FOR UNDEFINED GEOMETRY SEE 3D MODEL.
		DATE		
		LAST CHANGE	PALLAG DESIGN	
		DATE	19-Jul-2023	
		STATUS		
NO.	CHANGE	DATE	DESIGNER	SIZE: A3

APPLY A THIN BUT COVERING COAT OF SIKA SP-207 PRIMER
AND THEN APPLY SIKAFLEX 221 SEALANT

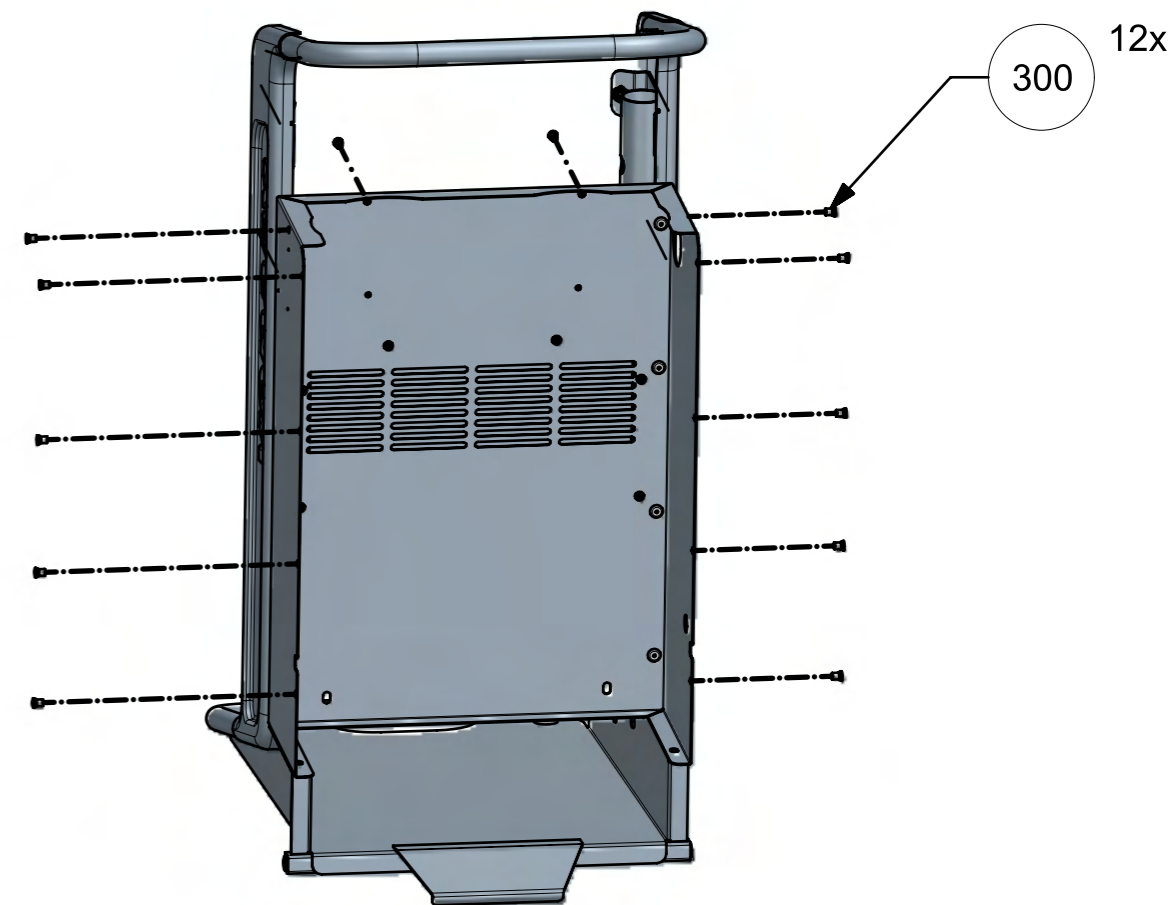
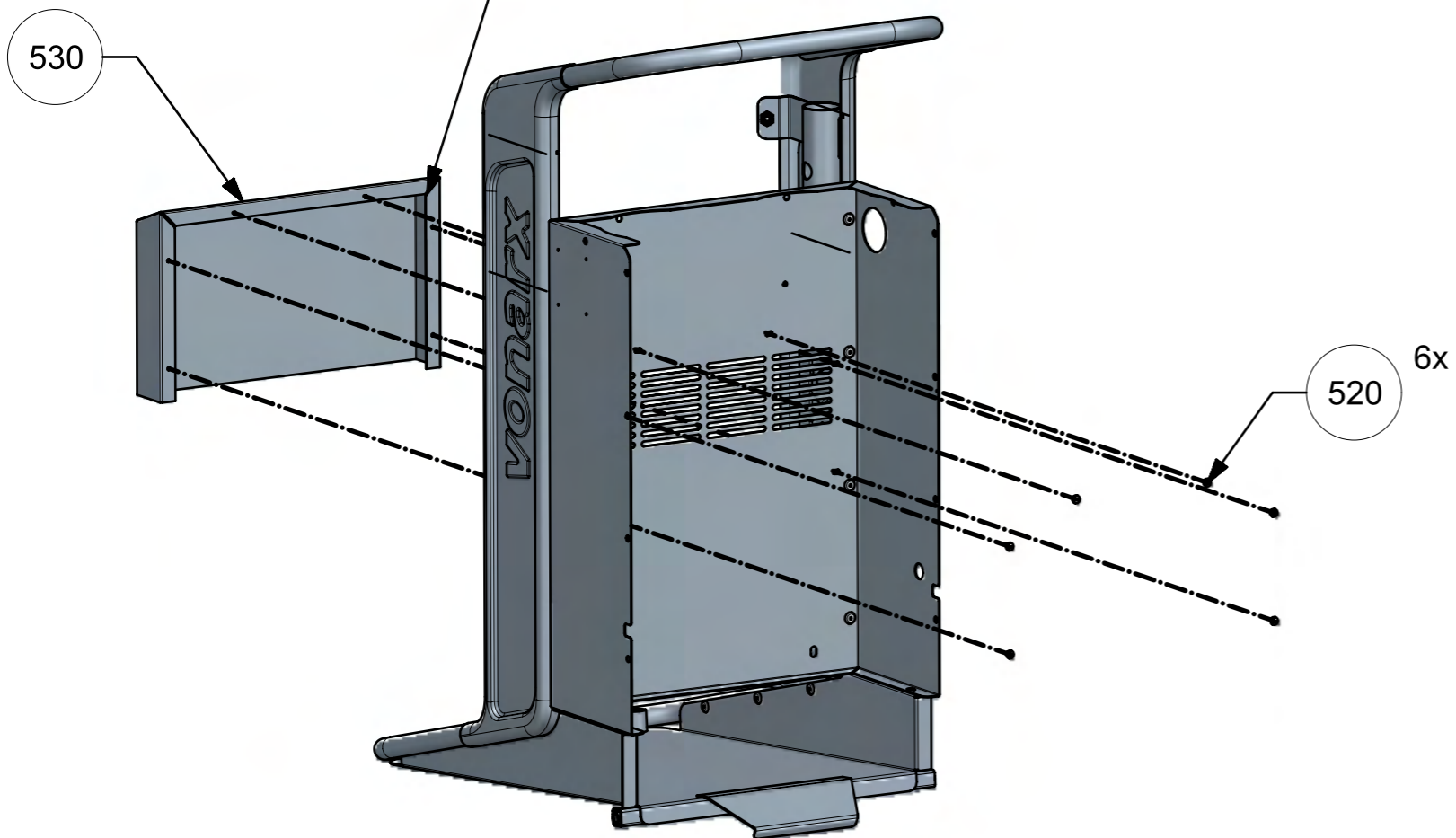

THE INFORMATION CONTAINED
IN THIS DRAWING IS THE SOLE
PROPERTY OF PUVAC HUNGARY KFT.
REPRODUCTION IN PART OR WHOLE
WITHOUT THE WRITTEN PERMISSION
OF PUVAC HUNGARY KFT. PROHIBITED.

ART.NR. 7001172 -		REV. 01	PROJECTION 	MATERIAL	
TITLE BASE FRAME - S2 CPL VONARX				FINISH -	
NOTES: -			DESIGNER	PALLAG DESIGN	PROJECT
			DATE		P2125-Puvac - Vacuum Cleaner
			LAST CHANGE	PALLAG DESIGN	UNLESS OTHERWISE SPECIFIED: DIMENSIONS ARE IN MILLIMETERS. FOR UNDEFINED MACHINING TOLERANCES USE ISO 2768-MK. FOR WELDING SS-EN ISO 13920-BF, MACHINED SURFACE FINISH ACCORDING TO ISO 1302. FOR UNDEFINED GEOMETRY SEE 3D MODEL.
			DATE	19-Jul-2023	
			STATUS		
NO.	CHANGE	DATE	DESIGNER	SHEET 3 / 5	SIZE: A3