

TOLERANCES acc. to ISO / TOLERANSER enl. ISO  
 Applicable where no tolerance is indicated.  
 Gäller där tolerans ej direkt utsatts  
 For machining / För bearbetning: ISO 2768-mK  
 For welding / För svetsning: SS-EN ISO 13920-BF  
 Surface finish acc. to ISO 1302 Machined surfaces.  
 Ytjämnhet enligt ISO 1302 För bearbetade ytor.

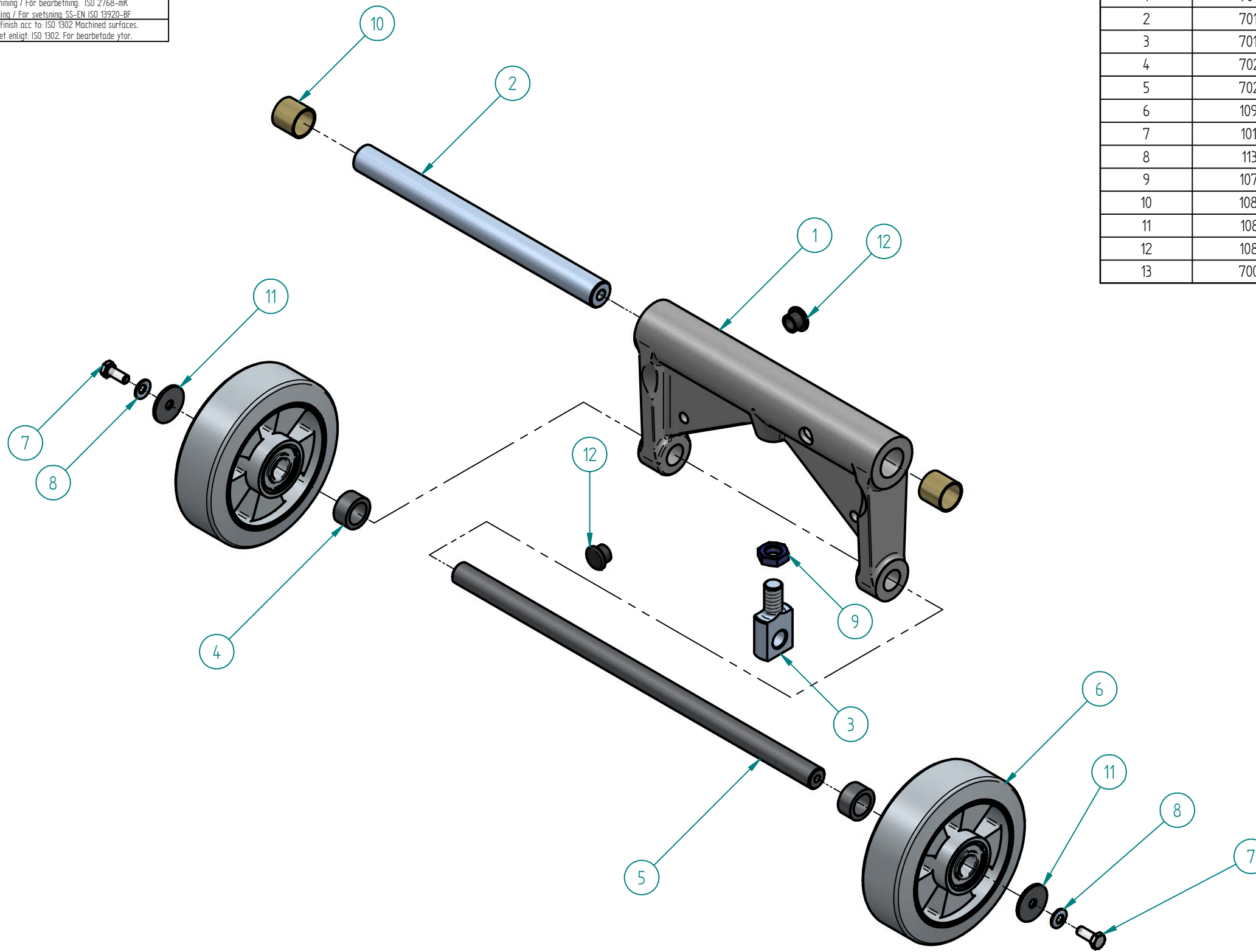

Item	Artikelnummer	Document Number	Title	Quantity
1	701625	630.02.02f	WHEEL BALANCE VA30-S	1
2	701626	630.02.03	AXLE FOR WHEEL BALANCE	1
3	701628	630.02.05c	JOINT PLATE	1
4	702614	655.01.03	DISTANCE TUBE	2
5	702617	655.01.06	WHEEL AXLE	1
6	109452	635.01.56	ELASTIC WHEEL TRACELESS GREY	2
7	101600	BN_56_M8x20	HEXAGONAL SCREW	2
8	113918	BN_13292_M8	RIP-LOCK LOCKING WASHER	2
9	107855	BN_124_M16	HEXAGON NUT	1
10	108486		CILINDRICAL BUSH	2
11	108581	BN_732_M8	WASHER WITHOUT CHAMFER	2
12	108459		SLIDER PE	2
13	700603		TUBE MOLYKOTE BR2 PLUS	0.002

				Material	Dimension	
Drawn By GS	Date 3.4.2019	Aproved Date 12.12.2019	Aproved By MS		Units : mm	SIZE A3
			Description CHASSIS VA30-S ASSEMBLED		Article Number 702806	
					DWG NO 655.37.00	
Part/Assembly File 6553700.asm				sheet 1	of 1	Rev.